

Box	Name and Subject	File Number	ID
EKMT 00014	54/14/7/6 (Vol.1) - Thames Coromandel County Council - Sand/Shingle Removal - Goat Bay, Okahutoki Stream (1976-1975)	15 47 01	10945



54/14/7/6 (1976) (1977) (1978)

File No. THAMES

DEPARTMENT:

ARCHIVED
DO NOT DESTROY

MOT
1-335

SERIES: COROMANDEL COUNTY COUNCIL

SUB-SERIES: SAND AND SHINGLE Rom

SUBJECT: MELSOPPS CROSSING, OKAHUAKI STR

PAPA AROHA, GOAT BAY.

File Opened: 1976-2010-72 File Closed: 09-78

Previous File: Subsequent File:

OTHER RELEVANT FILES

Subject: File No.

DISPOSAL CATEGORY: DIR

TRANSIT DIRECTIONS

Folio	Referred to	Date	Actioned by		Folio	Referred to	Date	Actioned by		Folio	Referred to	Date
			Initials	Date				Initials	Date			
	D. McLean		DM	11/77								
	M. Davies	28.10.77	MD	28.10.77								
	M. Davies	27.1.78	MD	27.1.78								
	M. Davies	2.2.78	MD	2.2.78								
	M. Davies	5.11.78	MD	5.11.78								

Handwritten notes and signatures:
Rom 003
MOT-205
A large diagonal line is drawn across the table.
A large handwritten signature 'M. Davies' is written across the table.



MINISTRY of TRANSPORT

MARINE DIVISION

PRIVATE BAG
AUCKLAND
TELEPHONE: 73-400

CUSTOM HOUSE
QUAY STREET
AUCKLAND

54/14/7/6

27.1. 1978

Thomas-Cromwell District Council

P. Bay

Thomas

Dear Sir

SAND AND SHINGLE LICENCES : PERIOD 1.1 TO 31.12. : AREA GOAT BAY

Receipt of your application is acknowledged. Reports are being obtained from our technical advisers and you will be informed of a decision in due course.

Yours faithfully

M. Harris

D. Greig
for Regional Secretary for Transport

Inspector of Mines and Quarries
P.O. Box 1701 34
AUCKLAND Hurstly

... Copy for your information and action. Please find enclosed an application from the above to extract sand/shingle. Would you please comment to this office at an early date regarding any infringement the application may have on any mineral warrant or mining right in the area.

M. Harris
D. Greig
for Regional Secretary for Transport

Encl.

The District Commissioner of Works
Ministry of Works and Development

Private Bag
Hamilton

... Copy for your information and Action. Would you please make a report in terms of the Harbours Act 1950 to this office on the enclosed application to remove sand/shingle with due regard to any erosion which could be caused by the extraction of material.

M. Harris
D. Greig
for Regional Secretary for Transport

Encl.



MINISTRY OF TRANSPORT
MARINE DIVISION

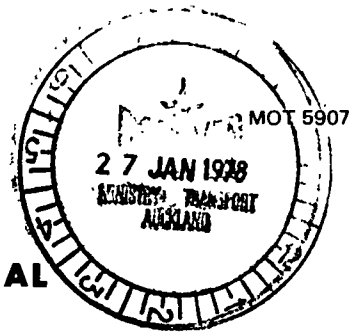

APPLICATION FOR REMOVAL OF MATERIAL
SECTION 146A — HARBOURS ACT 1950

Three copies of this application, together with the maps and plans listed in section 12, are to be sent to the local Superintendent of Mercantile Marine. Addresses are listed overleaf.

Thames-Coromandel District Council

1. Applicant's name:
2. Address: Private Bag, THAMES.
3. Description of material to be removed: Shingle
4. Area material to be removed from: Goat Bay,
- Coromandel Peninsular
5. Area described in Section 4 is: (tick in appropriate box)
 - (a) between mean high water and low water (ordinary spring tides)
 - (b) below low water ordinary spring tides (i.e. seabed)
6. Describe method of extraction and transportation: Front end loader and trucks
7. Purpose material required for: Roading and concrete aggregate
8. Quantity sought this calendar year: 600m³
9. Rate of removal (state whether per day, week or month); or for smaller quantities date(s) of removal:
- Varies approx. 50m³ per month
10. Quantity extracted under previous year's licence if the same area is sought: 600m³
11. Will an application for removal of material from this area be made next calendar year?
 - Yes Estimated quantity to be removed Similar
 - No
12. The following are attached:
 - (a) Three copies of form MOT 5908 showing the area from which material is to be removed.
 - (b) Three copies of map NZMS 177 showing the locality.

J. D. Bartlett

Signature: For K.C. Fenton Chief Engineer

Name of Company, etc., if applicable: **Thames-Coromandel District Council**

Date: 19 January 1978

ADDRESS OF LOCAL OFFICES OF SUPERINTENDENTS OF MERCANTILE MARINE
(An officer of Ministry of Transport or Customs Department)

The actual designation of each officer is shown with the address:

AUCKLAND	..	Regional Marine Officer, Ministry of Transport, Private Bag, Auckland.
BLUFF	..	District Administration Officer, Ministry of Transport, P.O. Box 18, Bluff.
CHATHAM ISLANDS	..	Superintendent of Mercantile Marine, Ministry of Transport, P.O. Box 72, Waitangi, Chatham Islands.
CHRISTCHURCH	..	Regional Marine Officer, Ministry of Transport, Private Bag, Christchurch.
DUNEDIN	..	District Officer, Ministry of Transport, Private Bag, Dunedin.
GISBORNE	..	Superintendent of Mercantile Marine, Customs Department, P.O. Box 17, Gisborne.
GREYMOUTH	..	Superintendent of Mercantile Marine, Customs Department, Box 40, Greymouth.
NAPIER	..	District Officer, Ministry of Transport, P.O. Box 4145, Mārewa, Napier.
NELSON	..	District Administration Officer, Ministry of Transport, P.O. Box 192, Nelson.
NEW PLYMOUTH	..	District Officer, Ministry of Transport, P.O. Box 4041, New Plymouth East.
PICTON	..	Superintendent Mercantile Marine, Ministry of Transport, P.O. Box 59, Picton.
TAURANGA	..	Superintendent of Mercantile Marine, Customs Department, P.O. Box 317, Tauranga.
TIMARU	..	Superintendent of Mercantile Marine, Customs Department, P.O. Box 64, Timaru.
WANGANUI	..	Superintendent of Mercantile Marine, Customs Department, P.O. Box 130, Wanganui.
WELLINGTON	..	Regional Marine Officer, Ministry of Transport, P.O. Box 27-144, Wellington.
WHANGAREI	..	District Administration Officer, Ministry of Transport, P.O. Box 150, Whangarei.
WESTPORT	..	Secretary Manager, Ministry of Transport, P.O. Box 29, Westport.



PLAN OF AREA SOUGHT FOR REMOVAL OF MATERIAL

SECTION 146A – HARBOURS ACT 1950

Instructions:

- (i) Complete in triplicate and attach to each copy of the application form MOT 5907.
- (ii) Show on this plan area of removal.
- (iii) Landmarks, adjacent title boundaries and measurements (or scale) are required.
- (iv) Attach to this plan – again three copies required – copies or tracing of portion NZMS map series 177 – arrow the area. Show NZMS map NUMBER from which tracing made.

NORTH

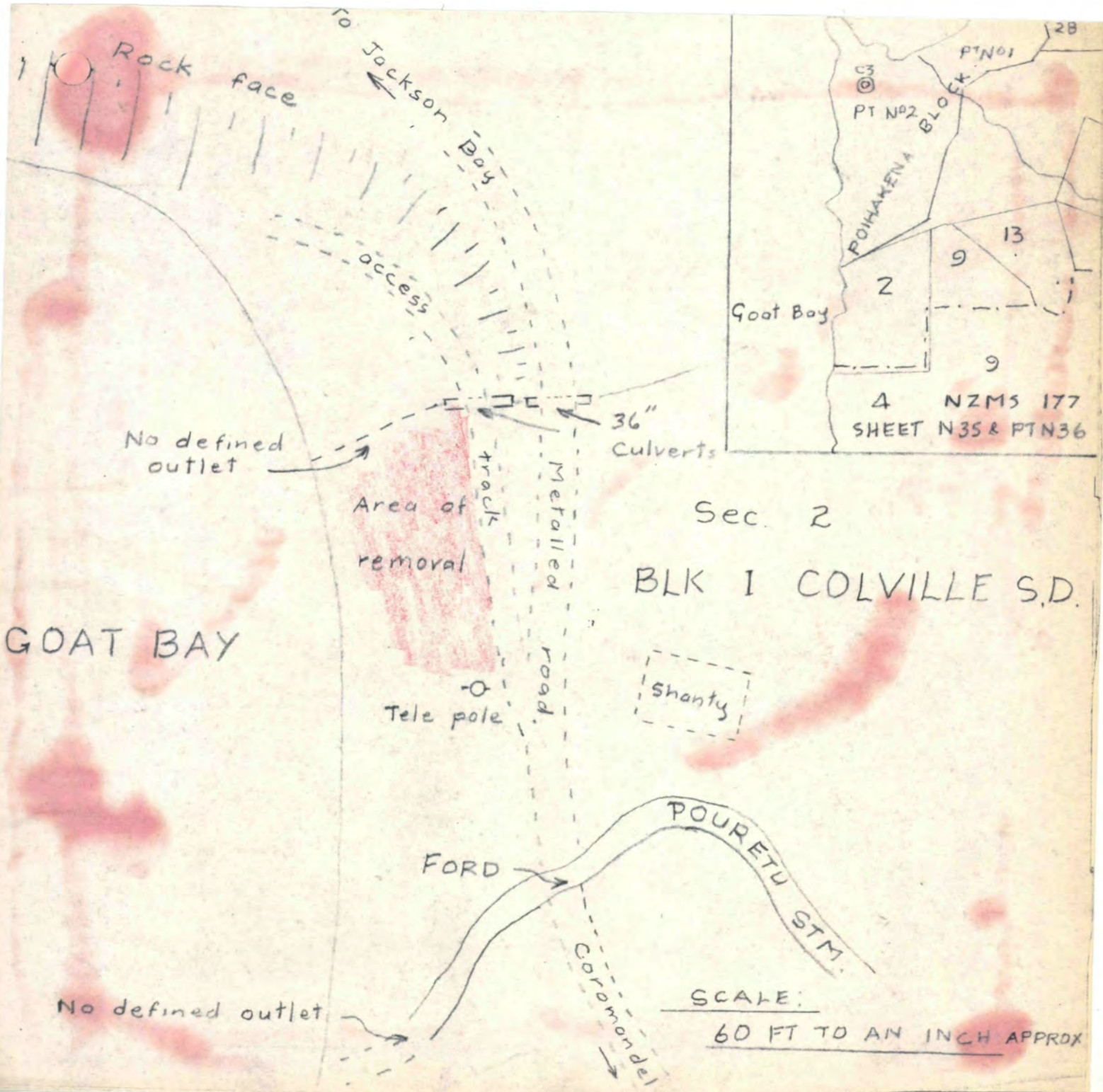

Enclosure No. 1

ENVIRONMENTAL ASSESSMENT

1. Describe the topography of the area from which material is to be extracted, and adjoining beach, e.g. cliffs, dunes. *Shingle beach backed by steep grassland.*
2. Describe length and depth of the foreshore concerned, or adjoining.
3. Describe specification of material required. *1"-2" Shingle*
4. Describe availability of this material at location applied for. *Continuous deposit by tidal action.*
5. Report nearest alternative source. *Mellsaps crossing.*
6. Report use of the material and demand for it. *Roading*
7. Report minimum quantity required. *600 m³*
8. Give details of present land use behind the beach, e.g. farming (type), residential, recreational, industrial. Nearest residential areas. *Farming.*
9. Describe vegetative cover behind the beach, e.g. grass, lupins, scrub. *Grass.*
10. Report probable effect on physical environment. *Nil*
11. Would the operation affect a scenic area. *No.*
12. Would the operation affect the ecology, fish, shell-fish or bird life. *No.*
13. Comment on any recreational activity on the beach or adjacent area which might be affected, e.g. boating, fishing, picnicing. *Some fishing Not affected.*
14. Would the operation involve the construction of buildings, stock piles or deep holes. *No.*
15. Method of extraction. *Loader.*
16. Alternative methods of extraction available. *Nil*
17. Report survey description of adjoining land and registered owner. *Public Road.*

- 19. Will the operation affect any historical or archeological sites. Check with New Zealand Historic Places Trust, Local Museum and New Zealand Archeological Association. *Nil*
- 20. Are the operations likely to be of substantial public interest. Has there been any previous public concern about this type of operation in the region. Have any complaints been received in the last two years. *No.*
- 21. Will the operation create pollution, siltation or erosion. *No.*

CONTROL OF PORT CHARGES TO T.C.D.C.
UNDER FORESHORE LICENCE ORDER 17/11/71.

MOT 1542

MINISTRY OF TRANSPORT

TELECOMMUNICATION MESSAGE FORM

Date Stamp

Post Bank Wharf

who is responsible

TCDC or MOT or

privately

submit reports when in

poor condition

MINISTRY OF TRANSPORT

TELECOMMUNICATION MESSAGE FORM

Date Stamp

Mr. Sutton H/M Port Charles
reports

Metal being removed from
H/Stone Port Charles by Paul
McLeod local contractor

(A) Have TCDC a permit license
to remove soil?

MINISTRY OF TRANSPORT

TELECOMMUNICATION MESSAGE FORM

Date Stamp

- (B) They T.C.O.E. did have one
in recent years
- (C) Was application made to
person?
- (D) Was a Mon & D report
requested & recommendations

DJG/JH

773-400

Our Ref: 54/14/7/6

Your Ref: D15/6/2

4 September 1978

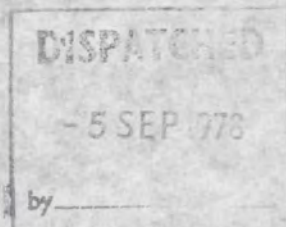

The General Manager
Thames Coromandel District Council
Private Bag
THAMES

Dear Sir:

SAND & SHINGLE REMOVAL LICENCES

Reports have been obtained from our Technical Advisors on your Council's applications for licences to remove sand and shingle for the year ending 31 March 1978.

PAPA AROHA The recommendation is that no licence be issued until there is an appreciable build up of the beach and on your Council advising this office when this has occurred consideration would be given to the issue of a licence. Subsequent removals by Council staff should then be under supervision of the District Engineer.

URAREMA STREAM
MELSOPS CROSSING

A licence is enclosed, but it is stressed that there are expressed reservations regarding the continuance of removals in future years.

GOAT BAY On the recommendation of our advisors no licence will be issued for this or subsequent years.

OKAHUTE STREAM

Application declined, however our advisors state that on application to the appropriate authority material could possibly be removed from the stream before it reaches the beach.

Yours faithfully

D.J. Greig
for Regional Secretary for Transport



This form must be produced when demanded by an officer or representative of the Ministry of Transport.

Reference: 54/14/7/6

LICENCE TO TAKE MATERIAL

Issued Pursuant to Section 146A of the Harbours Act 1950

To The General Manager

Address: James - Commandant Port General
Swire Bldg - Wharfedale

*See now what
is 54/14/c*

No 4157

You are hereby authorised on ~~payment of a licence fee of \$1~~ and subject to the terms and conditions set out below, to take and remove 1500 ^{cubic metres} cubic yards per of *stone, shingle, sand, boulders, silt, mud, from an area of the *foreshore below high-water mark, harbour, river bed, bed of the sea, described as Wharfedale Wharf - Melrose Quay

TERMS AND CONDITIONS

1. This licence shall expire on the 31 day of March 1979 unless sooner revoked in terms hereof.
2. The licensee shall pay to the Ministry of Transport a royalty of all material taken and removed at the rate of 4/c per cubic yard.
- *3. The licensee shall, on the first day of each month, produce for inspection to at his official log book as required by Section 177 of the Shipping and Seamen Act 1952, and his cargo book (if any), and shall thereupon pay all amounts (if any), due to date, or
- *4. The licensee shall, on the first day of each (month*) (or of the ~~quarters commencing in January, April, July, and October*~~), produce to Ministry of Transport Auckland a record of all material removed each day of the preceding (month*) (or quarter*), or, if no material has been removed during that period, advise him in writing accordingly, and shall thereupon pay all amounts (if any), due to date.
5. The licensee shall not remove any material from any place which, although included in the area above described, is used in whole or in part as a public road or highway.
6. The licensee shall not assign or subcontract out the benefit of this licence.
7. This licence may be revoked upon one week's written notice to the licensee at the above address and without notice if:
 - (a) The Ministry considers damage is being done or is likely to be done to adjacent land, or
 - (b) If the licensee, his servants, or agents shall fail to observe any term or condition hereof without in any event prejudicing the other rights of the Ministry including its right of recovery of payments due hereunder.

8. Further conditions: Your attention is drawn to the fact
that further removal in future years may be
declined

DATED this 4 day of September 1978

Signature: Denis John Green

Designation: General Manager



Thames - Coromandel District Council

TELEPHONES: 9 & 405 THAMES

PLEASE ADDRESS ALL CORRESPONDENCE TO: THE GENERAL MANAGER,
PRIVATE BAG, THAMES, N.Z.

If calling, please ask for
MR EDMONDS

Please quote reference,
D15/6/2

26 June 1978

Ministry of Transport,
Marine Division,
Private Bag,
AUCKLAND.

Dear Sir,

SHINGLE REMOVALS



Your 54/14/7/6 dated 6th June 1978 refers.

Our Area Engineer reports as follows:-

1. Melsopps: It is assumed that the untidy conditions referred to is the deep trench running parallel to the foreshore. This has not been caused by Council's operations but is a secondary channel formed by an existing tidal and stream condition. This trench is now 50% backfilled by tidal action.
2. Okahutahi Stream: No sand or shingle has been removed from this source by Council for approximately 2 years and then only when the build up of the stream bed necessitated removal to alleviate flooding.
3. Application for Licences: It is true that through an oversight applications for 1977 were either delayed or overlooked, but we are currently holding licences for 4 ~~areas~~ areas i.e. Melsopps, Goat Bay, Papa Aroha, Okahutahi Stream.

Assuring you of our co-operation in complying with the tenants of the Habours Act 1950 and avoidance of infringements.

Yours faithfully,

K.C. FENTON,
CHIEF ENGINEER,
THAMES-COROMANDEL DISTRICT

Per:



MINISTRY of TRANSPORT

MARINE DIVISION

PRIVATE BAG
AUCKLAND
TELEPHONE: 34466- 773-400

CUSTOM HOUSE
QUAY STREET
AUCKLAND

54/14/C

28 June 1978

The District Commissioner
Ministry of Works & Development
Private Bag
HAMILTON

EXTRACTION OF SAND AND SHINGLE RECOMMENDATION 1978/79

Recommendation for the following reports have not yet come to hand.

N. Whitehouse	Area Applied for	Waitete Bay	Requested 23.3.78 File 54/14/7/28	
P. Miller	"	"	Whangaruru N. Beach	Requested 7.4.78 File 54/14/5/26
M. R. Hodge	"	"	Kuaotunu N. Beach	Requested 1.3.78 File 54/14/7/5
Thames Coromandel District Council (see letter 6.6.78)	"	"	Melsopp Papa Aroha Goat Bay Okahatahi Stream	Requested 27.1.78 File 54/14/7/6
J. Gondie	"	"	Falcon Bay	Requested 15.11.77 File 54/14/7/34

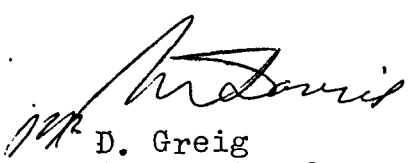
D. Greig
for Regional Secretary for Transport

Point now Newell

— 733-400

54/14/7/34

54/14/7/6

6 June 1978

The District Manager
Thames-Coromandel District Council
Private Bag
THAMES

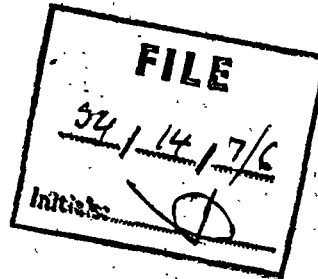

Dear Sir

SHINGLE REMOVALS

In course of reporting on proposals to remove sand and shingle during the period from 1 April 1978, our Technical Advisors have drawn our attention to the following:

1. Melsopps shingle in the order of 400 m³ to 500m³ has been removed by your Council in a manner which has left the foreshore in an untidy condition and not in accordance with the conditions which would have been applied to any licence issued.
2. Okahutahi Stream. Shingle and sand has been removed in a manner which would not have been permitted under licence and due to lack of material at the mouth of the river, material has been removed from the foreshore. Removal from this area in the view of our Technical Advisors is likely to cause erosion problems, particularly to the sand dune areas at the top of the beach, this view being supported by the Hauraki Catchment Board.

The file referring to your Council's licences for the removal of shingle has been examined and it is noted that the last licences issued to Council expired on 31.12.75, this Office being advised with your 10.5.6 of 14/2/77 that if the Council required the issue of licences for the year commencing 1/1/77, we would be advised no subsequent application was received for that period.

The removal of material from the foregoing areas was therefore without authority and without licence and thus did not allow the normal procedure to be followed to give our Advisors the opportunity to report on any proposal lodged. Such report would have taken into consideration effects of removals on the foreshore and dangers of erosion occurring through any proposed removals. Should erosion now occur as the result of unauthorised shingle removals the responsibility would now be directly with your Council.

Proposed removals of shingle now require reference by our advisors to the responsible Catchment Authority and their joint recommendations will be strictly adhered to in the issue of licences.

While no royalty accrues to this Ministry for the removal of materials from the foreshore and tidal lands by Local Authorities this Ministry can not condone such illegal actions by responsible authorities and require that the legislation covering the licensing of removal of material from Crown tidal lands be adhered to.

Your co-operation in complying with the tenants of the Harbour Act 1950 and avoidance of similar infringements is requested.

Yours faithfully

D. Greig
for Regional Secretary for Transport

The District Commissioner of Works
Ministry of Works & Development
Private Bag
HAMILTON

Copy for your information, your 47/16 of 10.5.78 and 7/2 (Paeroa) refers.

D. Greig
for Regional Secretary for Transport

Marima Shu

Enclosure No. 1

ENVIRONMENTAL ASSESSMENT

1. Describe the topography of the area from which material is to be extracted, and adjoining beach, e.g. cliffs, dunes. *Shingle beach backed by scrub covered flats rising to high country.*
2. Describe length and depth of the foreshore concerned, or adjoining.
3. Describe specification of material required. *1/2" - 1" shingle*
4. Describe availability of this material at location applied for. *Continuous deposit by tidal action.*
5. Report nearest alternative source. *Paha-aroa, or Goat Bay.*
6. Report use of the material and demand for it. *Roading & concrete.*
7. Report minimum quantity required. *1500 m³*
8. Give details of present land use behind the beach, e.g. farming (type), residential, recreational, industrial. Nearest residential areas. *Farming*
9. Describe vegetative cover behind the beach, e.g. grass, lupins, scrub. *Grass.*
10. Report probable effect on physical environment. *Nil*
11. Would the operation affect a scenic area. *No*
12. Would the operation affect the ecology, fish, shell-fish or bird life. *No.*
13. Comment on any recreational activity on the beach or adjacent area which might be affected, e.g. boating, fishing, picnicing. *Some camping in vicinity. Not affected.*
14. Would the operation involve the construction of buildings, stock piles or deep holes. *No.*
15. Method of extraction. *Loader.*
16. Alternative methods of extraction available. *Nil*
17. Report survey description of adjoining land and registered owner. *Public road.*

19. Will the operation affect any historical or archeological sites. Check with New Zealand Historic Places Trust, Local Museum and New Zealand Archeological Association.

Nil

20. Are the operations likely to be of substantial public interest. Has there been any previous public concern about this type of operation in the region. Have any complaints been received in the last two years.

No.

21. Will the operation create pollution, siltation or erosion.

No.

ENVIRONMENTAL ASSESSMENT

1. Describe the topography of the area from which material is to be extracted, and adjoining beach, e.g. cliffs, dunes. **Shingle beach.**
2. Describe length and depth of the foreshore concerned, or adjoining. **Approx. 20m x 120m**
3. Describe specification of material required. **Shingle**
4. Describe availability of this material at location applied for. **Continuous supply deposited by tidal action.**
5. Report nearest alternative source. **Goat Bay or Papa Aroha**
6. Report use of the material and demand for it. **Road maintenance and concret aggregate as required**
7. Report minimum quantity required. **1500m³**
8. Give details of present land use behind the beach, e.g. farming (type), residential, recreational, industrial. Nearest residential areas. **Dry stock farming Colville.**
9. Describe vegetative cover behind the beach, e.g. **Rough grass, Pohutakaws grass, lupins, scrub. and flax fronting public road. Rolling grass land behind.**
10. Report probable effect on physical environment. **Nil**
11. Would the operation affect a scenic area. **No**
12. Would the operation affect the ecology, fish, shell-fish or bird life. **No**
13. Comment on any recreational activity on the beach or adjacent area which might be affected, e.g. boating, fishing, picnicing. **Some roadside camping in the area but would not be affected by operations.**
14. Would the operation involve the construction of buildings, stock piles or deep holes. **No**
15. Method of extraction. **Front end loader.**
16. Alternative methods of extraction available. **Nil**
17. Report survey description of adjoining land and registered owner. **Lot 3, D.P.S. 22779
Block IV Moehou S.D.
M.C. Ward.**

19. Will the operation affect any historical or archeological sites. Check with New Zealand Historic Places Trust, Local Museum and New Zealand Archeological Association. NO
20. Are the operations likely to be of substantial public interest. Has there been any previous public concern about this type of operation in the region. Have any complaints been received in the last two years. NO
21. Will the operation create pollution, siltation or erosion. NO

ENVIRONMENTAL ASSESSMENT

1. Describe the topography of the area from which material is to be extracted, and adjoining beach, e.g. cliffs, dunes. **Shingle beach fronting public road.**
2. Describe length and depth of the foreshore concerned, or adjoining. **Approx. 20m x 105m**
3. Describe specification of material required. **Shingle**
4. Describe availability of this material at location applied for. **Continuous supply deposited by tidal action.**
5. Report nearest alternative source. **Melsopps**
6. Report use of the material and demand for it. **Road maintenance and concrete aggregate as required.**
7. Report minimum quantity required. **600m³**
8. Give details of present land use behind the beach, e.g. farming (type), residential, recreational, industrial. Nearest residential areas. **Dry stock farming, Colville.**
9. Describe vegetative cover behind the beach, e.g. grass, lupins, scrub. **Steep grassland.**
10. Report probable effect on physical environment. **Nil**
11. Would the operation affect a scenic area. **No**
12. Would the operation affect the ecology, fish, shellfish or bird life. **No**
13. Comment on any recreational activity on the beach or adjacent area which might be affected, e.g. boating, fishing, picnicing. **Picnicing to a minor degree, No affect**
14. Would the operation involve the construction of buildings, stock piles or deep holes. **No**
15. Method of extraction. **Front end loader.**
16. Alternative methods of extraction available. **Nil**
17. Report survey description of adjoining land and registered owner. **Sec. 2, Block 1 Colville S.D. Department of Land & Survey.**

19. Will the operation affect any historical or archeological sites. Check with New Zealand Historic Places Trust, Local Museum and New Zealand Archeological Association. No
20. Are the operations likely to be of substantial public interest. Has there been any previous public concern about this type of operation in the region. Have any complaints been received in the last two years. No
21. Will the operation create pollution, siltation or erosion. No



MINISTRY OF TRANSPORT
MARINE DIVISION



APPLICATION FOR REMOVAL OF MATERIAL
SECTION 146A - HARBOURS ACT 1950

Three copies of this application, together with the maps and plans listed in section 12, are to be sent to the local Superintendent of Mercantile Marine. Addresses are listed overleaf.

Thames-Coromandel District Council

1. Applicant's name:

2. Address: **PRIVATE BAG - THAMES.**

3. Description of material to be removed: **BEACH SHINGLE**

4. Area material to be removed from: **GOAT BAY**

..... **COROMANDEL PENN.**

5. Area described in Section 4 is: (tick in appropriate box)

(a) between mean high water and low water (ordinary spring tides)

(b) below low water ordinary spring tides (i.e. seabed)

6. Describe method of extraction and transportation:

..... **FRONT END LOADER & TRUCKS.**

7. Purpose material required for: **LOADING**

8. Quantity sought this calendar year: **600 m³**

9. Rate of removal (state whether per day, week or month); or for smaller quantities date(s) of removal:

..... **APPROX 50 m³ PER MONTH**

10. Quantity extracted under previous year's licence if the same area is sought: **APPROX 600 m³.**

11. Will an application for removal of material from this area be made next calendar year?

Yes Estimated quantity to be removed **AS ABOVE**

No

12. The following are attached:

(a) Three copies of form MOT 5908 showing the area from which material is to be removed.

(b) Three copies of map NZMS 177 showing the locality.

Signature:

Name of Company, etc., if applicable: **Thames-Coromandel District Council**

Date: **23-11-76**

ADDRESS OF LOCAL OFFICES OF SUPERINTENDENTS OF MERCANTILE MARINE
(An officer of Ministry of Transport or Customs Department)

The actual designation of each officer is shown with the address:

AUCKLAND	..	Regional Marine Officer, Ministry of Transport, Private Bag, Auckland.
BLUFF	..	District Administration Officer, Ministry of Transport, P.O. Box 18, Bluff.
CHATHAM ISLANDS	..	Superintendent of Mercantile Marine, Ministry of Transport, P.O. Box 72, Waitangi, Chatham Islands.
CHRISTCHURCH	..	Regional Marine Officer, Ministry of Transport, Private Bag, Christchurch.
DUNEDIN	..	District Officer, Ministry of Transport, Private Bag, Dunedin.
GISBORNE	..	Superintendent of Mercantile Marine, Customs Department, P.O. Box 17, Gisborne.
GREYMOOUTH	..	Superintendent of Mercantile Marine, Customs Department, Box 40, Greymouth.
NAPIER	..	District Officer, Ministry of Transport, P.O. Box 4145, Marewa, Napier.
NELSON	..	District Administration Officer, Ministry of Transport, P.O. Box 192, Nelson.
NEW PLYMOUTH	..	District Officer, Ministry of Transport, P.O. Box 4041, New Plymouth East.
PICTON	..	Superintendent Mercantile Marine, Ministry of Transport, P.O. Box 59, Picton.
TAURANGA	..	Superintendent of Mercantile Marine, Customs Department, P.O. Box 317, Tauranga.
TIMARU	..	Superintendent of Mercantile Marine, Customs Department, P.O. Box 64, Timaru.
WANGANUI	..	Superintendent of Mercantile Marine, Customs Department, P.O. Box 130, Wanganui.
WELLINGTON	..	Regional Marine Officer, Ministry of Transport, P.O. Box 27-144, Wellington.
WHANGAREI	..	District Administration Officer, Ministry of Transport, P.O. Box 150, Whangarei.
WESTPORT	..	Secretary Manager, Ministry of Transport, P.O. Box 29, Westport.



PLAN OF AREA SOUGHT FOR REMOVAL OF MATERIAL

SECTION 146A – HARBOURS ACT 1950

Instructions:

- (i) Complete in triplicate and attach to each copy of the application form MOT 5907.
- (ii) Show on this plan area of removal.
- (iii) Landmarks, adjacent title boundaries and measurements (or scale) are required.
- (iv) Attach to this plan – again three copies required – copies or tracing of portion NZMS map series 177 – arrow the area. Show NZMS map NUMBER from which tracing made.

NORTH





MINISTRY OF TRANSPORT
MARINE DIVISION



APPLICATION FOR REMOVAL OF MATERIAL
SECTION 140A HARBOURS ACT 1950

Three copies of this application, together with the maps and plans listed in section 12, are to be sent to the local Superintendent of Mercantile Marine. Addresses are listed overleaf.

Thames-Coromandel District Council

1. Applicant's name:

2. Address: PRIVATE BAG THAMES

3. Description of material to be removed: BEACH SHINGLES

4. Area material to be removed from: PAPA-ARUHA

..... COROMANDEL PENN

5. Area described in Section 4 is: (tick in appropriate box)

(a) between mean high water and low water (ordinary spring tides)

(b) below low water ordinary spring tides (i.e. seabed)

6. Describe method of extraction and transportation: FRONT END LOADER & TRUCKS

7. Purpose material required for: ROADING ~~AND~~

8. Quantity sought this calendar year: 1000 m³

9. Rate of removal (state whether per day, week or month); or for smaller quantities date(s) of removal:

..... APPROX 80 m³ PER MONTH (VARIES)

10. Quantity extracted under previous year's licence if the same area is sought: 1000 m³

11. Will an application for removal of material from this area be made next calendar year?

Yes Estimated quantity to be removed SIMILAR

No

12. The following are attached:

(a) Three copies of form MOT 5908 showing the area from which material is to be removed.

(b) Three copies of map NZMS 177 showing the locality.

Signature:

Name of Company, etc., if applicable: **Thames-Coromandel District Council**

Date: 19-11-76

ADDRESS OF LOCAL OFFICES OF SUPERINTENDENTS OF MERCANTILE MARINE
(An officer of Ministry of Transport or Customs Department)

The actual designation of each officer is shown with the address:

AUCKLAND	.. .	Regional Marine Officer, Ministry of Transport, Private Bag, Auckland.
BLUFF	District Administration Officer, Ministry of Transport, P.O. Box 18, Bluff.
CHATHAM ISLANDS	..	Superintendent of Mercantile Marine, Ministry of Transport, P.O. Box 72, Waitangi, Chatham Islands.
CHRISTCHURCH	..	Regional Marine Officer, Ministry of Transport, Private Bag, Christchurch.
DUNEDIN	District Officer, Ministry of Transport, Private Bag, Dunedin.
GISBORNE	Superintendent of Mercantile Marine, Customs Department, P.O. Box 17, Gisborne.
GREYMOUTH	Superintendent of Mercantile Marine, Customs Department, Box 40, Greymouth.
NAPIER	District Officer, Ministry of Transport, P.O. Box 4145, Marewa, Napier.
NELSON	District Administration Officer, Ministry of Transport, P.O. Box 192, Nelson.
NEW PLYMOUTH	..	District Officer, Ministry of Transport, P.O. Box 4041, New Plymouth East.
PICTON	Superintendent Mercantile Marine, Ministry of Transport, P.O. Box 59, Picton.
TAURANGA	Superintendent of Mercantile Marine, Customs Department, P.O. Box 317, Tauranga.
TIMARU	Superintendent of Mercantile Marine, Customs Department, P.O. Box 64, Timaru.
WANGANUI	Superintendent of Mercantile Marine, Customs Department, P.O. Box 130, Wanganui.
WELLINGTON	Regional Marine Officer, Ministry of Transport, P.O. Box 27-144, Wellington.
WHANGAREI	District Administration Officer, Ministry of Transport, P.O. Box 150, Whangarei.
WESTPORT	Secretary Manager, Ministry of Transport, P.O. Box 29, Westport.



PLAN OF AREA SOUGHT FOR REMOVAL OF MATERIAL

SECTION 146A - HARBOURS ACT 1950

Instructions:

- (i) Complete in triplicate and attach to each copy of the application form MOT 5907.
- (ii) Show on this plan area of removal.
- (iii) Landmarks, adjacent title boundaries and measurements (or scale) are required.
- (iv) Attach to this plan - again three copies required - copies or tracing of portion NZMS map series 177 - arrow the area. Show NZMS map NUMBER from which tracing made.

NORTH

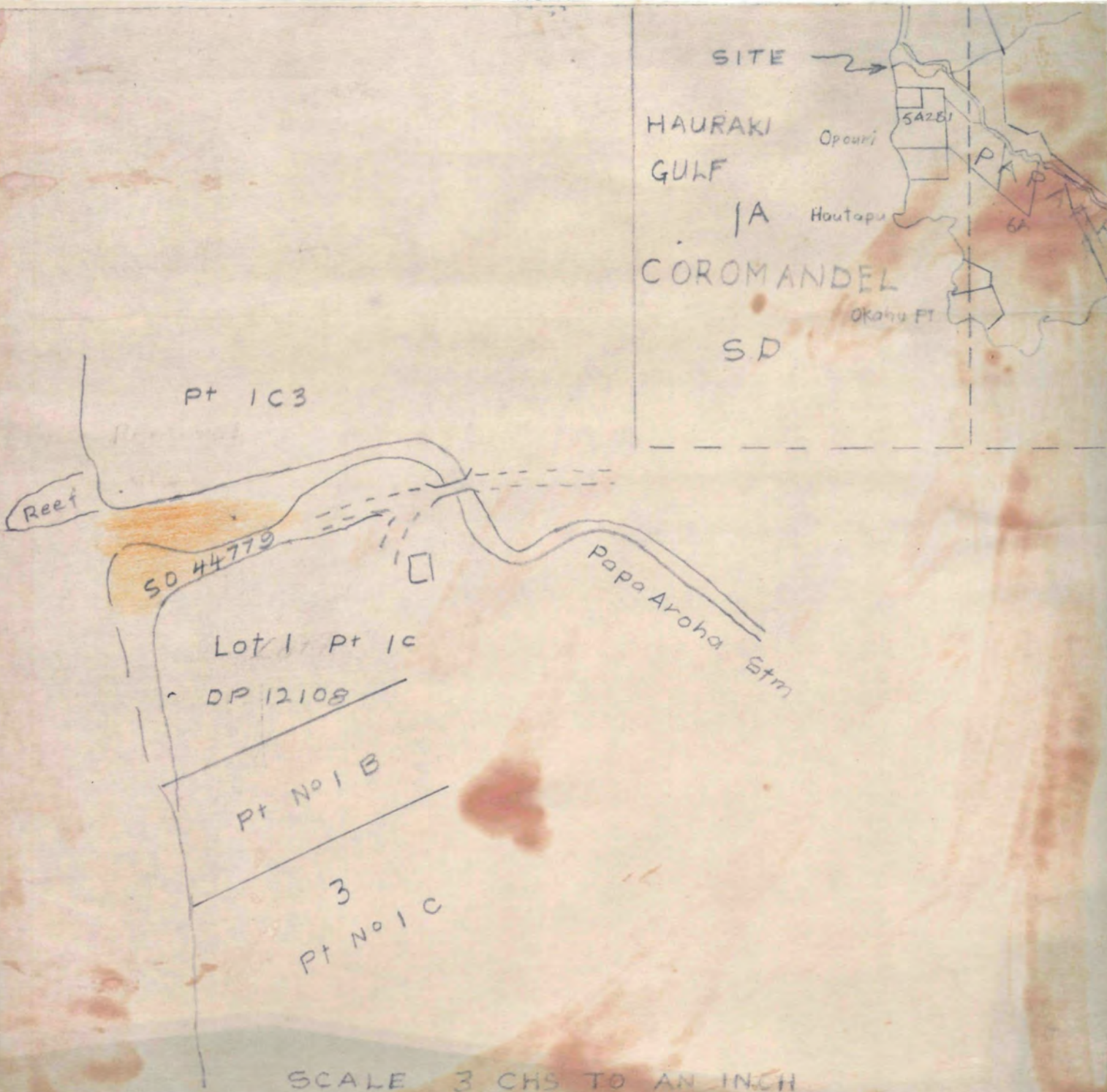

SCALE 3 CHS TO AN INCH

12/8.
54/14/7/6.
54/14/7/4.

Telephone 87-257
Huntly

Mines Dept,
P.O. Box 34,
HUNTLY

1 February, 1978.

Regional Secretary for Transport,
(in duplicate),
Marine Division,
Ministry of Transport,
Private Bag,
AUCKLAND.

SAND AND SHINGLE LICENSES.

Your letters of 23 and 27 January 1978 refer.

The applications as under do not appear to infringe any
mining privilege or application:-

- (a) Thames-Coromandel District Council,
(i) Melsopps,
(ii) Papa Aroha,
(iii) Goat Bay,
(iv) Okahutahi Stream.
- (b) A.A. Simpson, Kuaotunu Beach.

.....
(A.G. Palmer)
Inspector of Mines & Quarries.





Thames - Coromandel District Council

TELEPHONES: 9 & 405 THAMES

PLEASE ADDRESS ALL CORRESPONDENCE TO: THE GENERAL MANAGER,
PRIVATE BAG, THAMES, N.Z.

If calling, please ask for

Mr Edmonds

Please quote reference.

D15/5/2

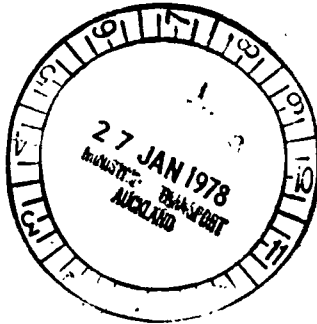

25 January 1978

Marine Division,
Ministry of Transport,
Northern Regional Office,
Private Bag,
AUCKLAND.

Dear Sir,

Re: Application for Removal of Material 1978

Herewith application forms MOT 5907 and 5908 for removal of
shingle from following sources :-

- (1) Papa Aroha
- (2) Urarima Stn - Mellsoys Crossings
- (3) Okahutahi Stm
- (4) Goat Bay

Yours faithfully,

K.C. Fenton,
CHIEF ENGINEER.

Per: 



MINISTRY of TRANSPORT

MARINE DIVISION

PRIVATE BAG
AUCKLAND
TELEPHONE: 34100-73-400

CUSTOM HOUSE
QUAY STREET
AUCKLAND

54/14/7/6

27/1 1978

Shannon Harbour District Council
P. Bag
Shannon

Dear Sir

SAND AND SHINGLE LICENCES : PERIOD 1.1 TO 31.12. : AREA OKAHUTAH Stream

Receipt of your application is acknowledged. Reports are being obtained from our technical advisers and you will be informed of a decision in due course.

Yours faithfully

M. Greig
D. Greig
for Regional Secretary for Transport

Inspector of Mines and Quarries
P.O. Box 1701 34
AUCKLAND Huntly

... Copy for your information and action. Please find enclosed an application from the above to extract ~~sand~~/shingle. Would you please comment to this office at an early date regarding any infringement the application may have on any mineral warrant or mining right in the area.

M. Greig
pp. D. Greig
for Regional Secretary for Transport
Encl.

The District Commissioner of Works
Ministry of Works and Development
Private Bag
Hamilton

... Copy for your information and Action. Would you please make a report in terms of the Harbours Act 1950 to this office on the enclosed application to remove ~~sand~~/shingle with due regard to any erosion which could be caused by the extraction of material.

M. Greig
pp. D. Greig
for Regional Secretary for Transport
Encl.



APPLICATION FOR REMOVAL OF MATERIAL
SECTION 146A - HARBOURS ACT 1950

Three copies of this application, together with the maps and plans listed in section 12, are to be sent to the local Superintendent of Mercantile Marine. Addresses are listed overleaf.

Thames-Coromandel District Council

1. Applicant's name:
2. Address: PRIVATE BAG, THAMES
3. Description of material to be removed: BEACH SHINGLES
4. Area material to be removed from: URARIMA STRM - MELLISOPPS CROSSING
..... COROMANDEL PENN.
5. Area described in Section 4 is: (tick in appropriate box)
 - (a) between mean high water and low water (ordinary spring tides)
 - (b) below low water ordinary spring tides (i.e. seabed)
6. Describe method of extraction and transportation:
..... FRONT END LOADER & TRUCKS
7. Purpose material required for: ROADING & CONCRETE AGGREGATE
8. Quantity sought this calendar year: 1500 m³
9. Rate of removal (state whether per day, week or month); or for smaller quantities date(s) of removal:
..... APPROX 125 m³ PER MONTH
10. Quantity extracted under previous year's licence if the same area is sought: 1500 m³
11. Will an application for removal of material from this area be made next calendar year?
 - Yes Estimated quantity to be removed AS ABOVE
 - No
12. The following are attached:
 - (a) Three copies of form MOT 5908 showing the area from which material is to be removed.
 - (b) Three copies of map NZMS 177 showing the locality.

Signature:

Name of Company, etc., if applicable: **Thames-Coromandel District Council**

Date: 19-11-76

ADDRESS OF LOCAL OFFICES OF SUPERINTENDENTS OF MERCANTILE MARINE
(An officer of Ministry of Transport or Customs Department)

The actual designation of each officer is shown with the address:

AUCKLAND	..	Regional Marine Officer, Ministry of Transport, Private Bag, Auckland.
BLUFF	..	District Administration Officer, Ministry of Transport, P.O. Box 18, Bluff.
CHATHAM ISLANDS	..	Superintendent of Mercantile Marine, Ministry of Transport, P.O. Box 72, Waitangi, Chatham Islands.
CHRISTCHURCH	..	Regional Marine Officer, Ministry of Transport, Private Bag, Christchurch.
DUNEDIN	..	District Officer, Ministry of Transport, Private Bag, Dunedin.
GISBORNE	..	Superintendent of Mercantile Marine, Customs Department, P.O. Box 17, Gisborne.
GREYMOUTH	..	Superintendent of Mercantile Marine, Customs Department, Box 40, Greymouth.
NAPIER	..	District Officer, Ministry of Transport, P.O. Box 4145, Marewa, Napier.
NELSON	..	District Administration Officer, Ministry of Transport, P.O. Box 192, Nelson.
NEW PLYMOUTH	..	District Officer, Ministry of Transport, P.O. Box 4041, New Plymouth East.
PICTON	..	Superintendent Mercantile Marine, Ministry of Transport, P.O. Box 59, Picton.
TAURANGA	..	Superintendent of Mercantile Marine, Customs Department, P.O. Box 317, Tauranga.
TIMARU	..	Superintendent of Mercantile Marine, Customs Department, P.O. Box 64, Timaru.
WANGANUI	..	Superintendent of Mercantile Marine, Customs Department, P.O. Box 130, Wanganui.
WELLINGTON	..	Regional Marine Officer, Ministry of Transport, P.O. Box 27-144, Wellington.
WHANGAREI	..	District Administration Officer, Ministry of Transport, P.O. Box 150, Whangarei.
WESTPORT	..	Secretary Manager, Ministry of Transport, P.O. Box 29, Westport.



PLAN OF AREA SOUGHT FOR REMOVAL OF MATERIAL

SECTION 146A - HARBOURS ACT 1950

Instructions:

- (i) Complete in triplicate and attach to each copy of the application form MOT 5907.
- (ii) Show on this plan area of removal.
- (iii) Landmarks, adjacent title boundaries and measurements (or scale) are required.
- (iv) Attach to this plan - again three copies required - copies or tracing of portion NZMS map series 177 - arrow the area. Show NZMS map NUMBER from which tracing made.

NORTH

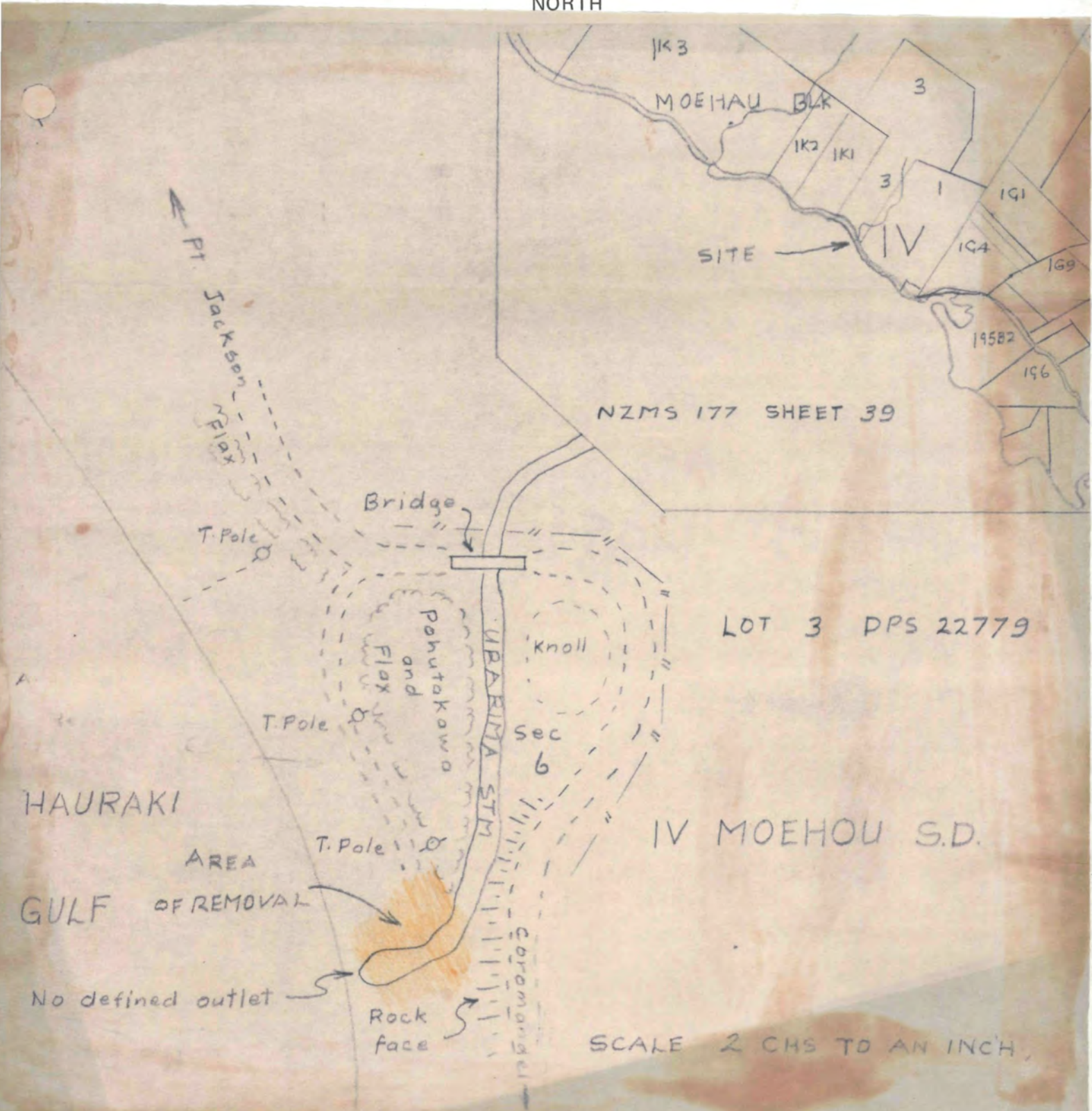

HAURAKI

GULF OF REMOVAL

SCALE 2 CHS TO AN INCH



APPLICATION FOR REMOVAL OF MATERIAL
SECTION 146A - HARBOURS ACT 1950

Three copies of this application, together with the maps and plans listed in section 12, are to be sent to the local Superintendent of Mercantile Marine. Addresses are listed overleaf.

Thames-Coromandel District Council

1. Applicant's name:
2. Address: Private Bag, THAMES.
3. Description of material to be removed: Shingle
4. Area material to be removed from: Okahutahi Stream
..... Sandy Bay
..... Port Charles
5. Area described in Section 4 is: (tick in appropriate box)
 - (a) between mean high water and low water (ordinary spring tides)
 - (b) below low water ordinary spring tides (i.e. seabed)
6. Describe method of extraction and transportation: Front end loader and trucks
7. Purpose material required for: Road Maintenance
8. Quantity sought this calendar year: 300m³
9. Rate of removal (state whether per day, week or month); or for smaller quantities date(s) of removal: Varies, this material is generally taken to improve the waterway area adjacent to the Okahutahi stream bridge. Say 100m³ bi-annually
10. Quantity extracted under previous year's licence if the same area is sought: 200m³
11. Will an application for removal of material from this area be made next calendar year?
 - Yes Estimated quantity to be removed 300m³
 - No
12. The following are attached:
 - (a) Three copies of form MOT 5908 showing the area from which material is to be removed.
 - (b) Three copies of map NZMS 177 showing the locality.

Signature: For K.C. Fenton Chief Engineer

Thames-Coromandel District Council

Name of Company, etc., if applicable:

Date: 19 January 1978

ADDRESS OF LOCAL OFFICES OF SUPERINTENDENTS OF MERCANTILE MARINE
(An officer of Ministry of Transport or Customs Department)

The actual designation of each officer is shown with the address:

AUCKLAND	..	Regional Marine Officer, Ministry of Transport, Private Bag, Auckland.
BLUFF	..	District Administration Officer, Ministry of Transport, P.O. Box 18, Bluff.
CHATHAM ISLANDS	..	Superintendent of Mercantile Marine, Ministry of Transport, P.O. Box 72, Waitangi, Chatham Islands.
CHRISTCHURCH	..	Regional Marine Officer, Ministry of Transport, Private Bag, Christchurch.
DUNEDIN	..	District Officer, Ministry of Transport, Private Bag, Dunedin.
GISBORNE	..	Superintendent of Mercantile Marine, Customs Department, P.O. Box 17, Gisborne.
GREYMOOUTH	..	Superintendent of Mercantile Marine, Customs Department, Box 40, Greymouth.
NAPIER	..	District Officer, Ministry of Transport, P.O. Box 4145, Marewa, Napier.
NELSON	..	District Administration Officer, Ministry of Transport, P.O. Box 192, Nelson.
NEW PLYMOUTH	..	District Officer, Ministry of Transport, P.O. Box 4041, New Plymouth East.
PICTON	..	Superintendent Mercantile Marine, Ministry of Transport, P.O. Box 59, Picton.
TAURANGA	..	Superintendent of Mercantile Marine, Customs Department, P.O. Box 317, Tauranga.
TIMARU	..	Superintendent of Mercantile Marine, Customs Department, P.O. Box 64, Timaru.
WANGANUI	..	Superintendent of Mercantile Marine, Customs Department, P.O. Box 130, Wanganui.
WELLINGTON	..	Regional Marine Officer, Ministry of Transport, P.O. Box 27-144, Wellington.
WHANGAREI	..	District Administration Officer, Ministry of Transport, P.O. Box 150, Whangarei.
WESTPORT	..	Secretary Manager, Ministry of Transport, P.O. Box 29, Westport.



PLAN OF AREA SOUGHT FOR REMOVAL OF MATERIAL

SECTION 146A - HARBOURS ACT 1950

Instructions:

- (i) Complete in triplicate and attach to each copy of the application form MOT 5907.
- (ii) Show on this plan area of removal.
- (iii) Landmarks, adjacent title boundaries and measurements (or scale) are required.
- (iv) Attach to this plan - again three copies required - copies or tracing of portion NZMS map series 177 - arrow the area. Show NZMS map NUMBER from which tracing made.

NORTH



ENVIRONMENTAL ASSESSMENT

1. Describe the topography of the area from which material is to be extracted, and adjoining beach, e.g. cliffs, dunes. *Shingle bearing stream adjacent to sand beach.*
2. Describe length and depth of the foreshore concerned, or adjoining.
3. Describe specification of material required. *beach shingle*
4. Describe availability of this material at location applied for. *Continual deposits from upper reaches of stream*
5. Report nearest alternative source. *Uranima Stm. - Mellsops.*
6. Report use of the material and demand for it. *Roading*
7. Report minimum quantity required. *200m³*
8. Give details of present land use behind the beach, e.g. farming (type), residential, recreational, industrial. Nearest residential areas. *Holiday homes & farming.*
9. Describe vegetative cover behind the beach, e.g. grass, lupins, scrub. *Grass.*
10. Report probable effect on physical environment. *Nil*
11. Would the operation affect a scenic area. *No*
12. Would the operation affect the ecology, fish, shell-fish or bird life. *No.*
13. Comment on any recreational activity on the beach or adjacent area which might be affected, e.g. boating, fishing, picnicing. *No recreational activity is affected. Removal of shingle relieves flooding problems*
14. Would the operation involve the construction of buildings, stock piles or deep holes. *No.*
15. Method of extraction. *Loaders*
16. Alternative methods of extraction available. *Nil*
17. Report survey description of adjoining land and registered owner. *Public Rd.*

- 19. Will the operation affect any historical or archeological sites. Check with New Zealand Historic Places Trust, Local Museum and New Zealand Archeological Association.
- 20. Are the operations likely to be of substantial public interest. Has there been any previous public concern about this type of operation in the region. Have any complaints been received in the last two years.
- 21. Will the operation create pollution, siltation or erosion.

No

No

No.



MINISTRY of TRANSPORT

MARINE DIVISION

PRIVATE BAG
AUCKLAND
TELEPHONE: 73-400

CUSTOM HOUSE
QUAY STREET
AUCKLAND

54/14/1 / 6

27/11 1975

James - Peromandel North Island

P. B.

James

Dear Sir

SAND AND SHINGLE LICENCES : PERIOD 1.1 TO 31.12. : AREA MELSO PPS

Receipt of your application is acknowledged. Reports are being obtained from our technical advisers and you will be informed of a decision in due course.

Yours faithfully

M. Davis

D. Greig
for Regional Secretary for Transport

Inspector of Mines and Quarries
P.O. Box 1701 34
AUCKLAND

Huntly

... Copy for your information and action. Please find enclosed an application from the above to extract sand/shingle. Would you please comment to this office at an early date regarding any infringement the application may have on any mineral warrant or mining right in the area.

M. Davis

D. Greig
for Regional Secretary for Transport

Encl.

The District Commissioner of Works
Ministry of Works and Development

Private Bag
Hamilton

... Copy for your information and Action. Would you please make a report in terms of the Harbours Act 1950 to this office on the enclosed application to remove sand/shingle with due regard to any erosion which could be caused by the extraction of material.

M. Davis

D. Greig
for Regional Secretary for Transport

Encl.



MINISTRY OF TRANSPORT
MARINE DIVISION

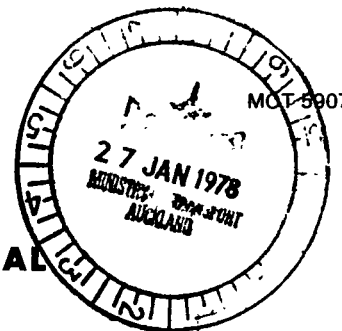

APPLICATION FOR REMOVAL OF MATERIAL
SECTION 146A - HARBOURS ACT 1950

Three copies of this application, together with the maps and plans listed in section 12, are to be sent to the local Superintendent of Mercantile Marine. Addresses are listed overleaf.

Thames-Coromandel District Council

1. Applicant's name:
2. Address: **Private Bag, THAMES.**
3. Description of material to be removed: **Shingle**
4. Area material to be removed from: **Melsopps**
..... **Coromandel Peninsula**
5. Area described in Section 4 is: (tick in appropriate box)
 - (a) between mean high water and low water (ordinary spring tides)
 - (b) below low water ordinary spring tides (i.e. seabed)
6. Describe method of extraction and transportation: **Front end loader and trucks**
7. Purpose material required for: **Roading and concrete aggregate**
8. Quantity sought this calendar year: **1500m³**
9. Rate of removal (state whether per day, week or month); or for smaller quantities date(s) of removal:
..... **Varies depending on tidal conditions**
..... **Approx. 125m³ per month**
10. Quantity extracted under previous year's licence if the same area is sought: **1500m³**
11. Will an application for removal of material from this area be made next calendar year?
Yes Estimated quantity to be removed **Similar**
No
12. The following are attached:
 - (a) Three copies of form MOT 5908 showing the area from which material is to be removed.
 - (b) Three copies of map NZMS 177 showing the locality.

J. D. Bortlett

Signature: **For K.C. Fenton, Chief Engineer**

Name of Company, etc., if applicable: **Thames-Coromandel District Council**

Date: **19 January 1978**

ADDRESS OF LOCAL OFFICES OF SUPERINTENDENTS OF MERCANTILE MARINE
(An officer of Ministry of Transport or Customs Department)

The actual designation of each officer is shown with the address:

AUCKLAND	..	Regional Marine Officer, Ministry of Transport, Private Bag, Auckland.
BLUFF	..	District Administration Officer, Ministry of Transport, P.O. Box 18, Bluff.
CHATHAM ISLANDS	..	Superintendent of Mercantile Marine, Ministry of Transport, P.O. Box 72, Waitangi, Chatham Islands.
CHRISTCHURCH	..	Regional Marine Officer, Ministry of Transport, Private Bag, Christchurch.
DUNEDIN	..	District Officer, Ministry of Transport, Private Bag, Dunedin.
GISBORNE	..	Superintendent of Mercantile Marine, Customs Department, P.O. Box 17, Gisborne.
GREYMOUTH	..	Superintendent of Mercantile Marine, Customs Department, Box 40, Greymouth.
NAPIER	..	District Officer, Ministry of Transport, P.O. Box 4145, Marewa, Napier.
NELSON	..	District Administration Officer, Ministry of Transport, P.O. Box 192, Nelson.
NEW PLYMOUTH	..	District Officer, Ministry of Transport, P.O. Box 4041, New Plymouth East.
PICTON	..	Superintendent Mercantile Marine, Ministry of Transport, P.O. Box 59, Picton.
TAURANGA	..	Superintendent of Mercantile Marine, Customs Department, P.O. Box 317, Tauranga.
TIMARU	..	Superintendent of Mercantile Marine, Customs Department, P.O. Box 64, Timaru.
WANGANUI	..	Superintendent of Mercantile Marine, Customs Department, P.O. Box 130, Wanganui.
WELLINGTON	..	Regional Marine Officer, Ministry of Transport, P.O. Box 27-144, Wellington.
WHANGAREI	..	District Administration Officer, Ministry of Transport, P.O. Box 150, Whangarei.
WESTPORT	..	Secretary Manager, Ministry of Transport, P.O. Box 29, Westport.



PLAN OF AREA SOUGHT FOR REMOVAL OF MATERIAL

SECTION 146A – HARBOURS ACT 1950

Instructions:

- (i) Complete in triplicate and attach to each copy of the application form MOT 5907.
- (ii) Show on this plan area of removal.
- (iii) Landmarks, adjacent title boundaries and measurements (or scale) are required.
- (iv) Attach to this plan – again three copies required – copies or tracing of portion NZMS map series 177 – arrow the area. Show NZMS map NUMBER from which tracing made.

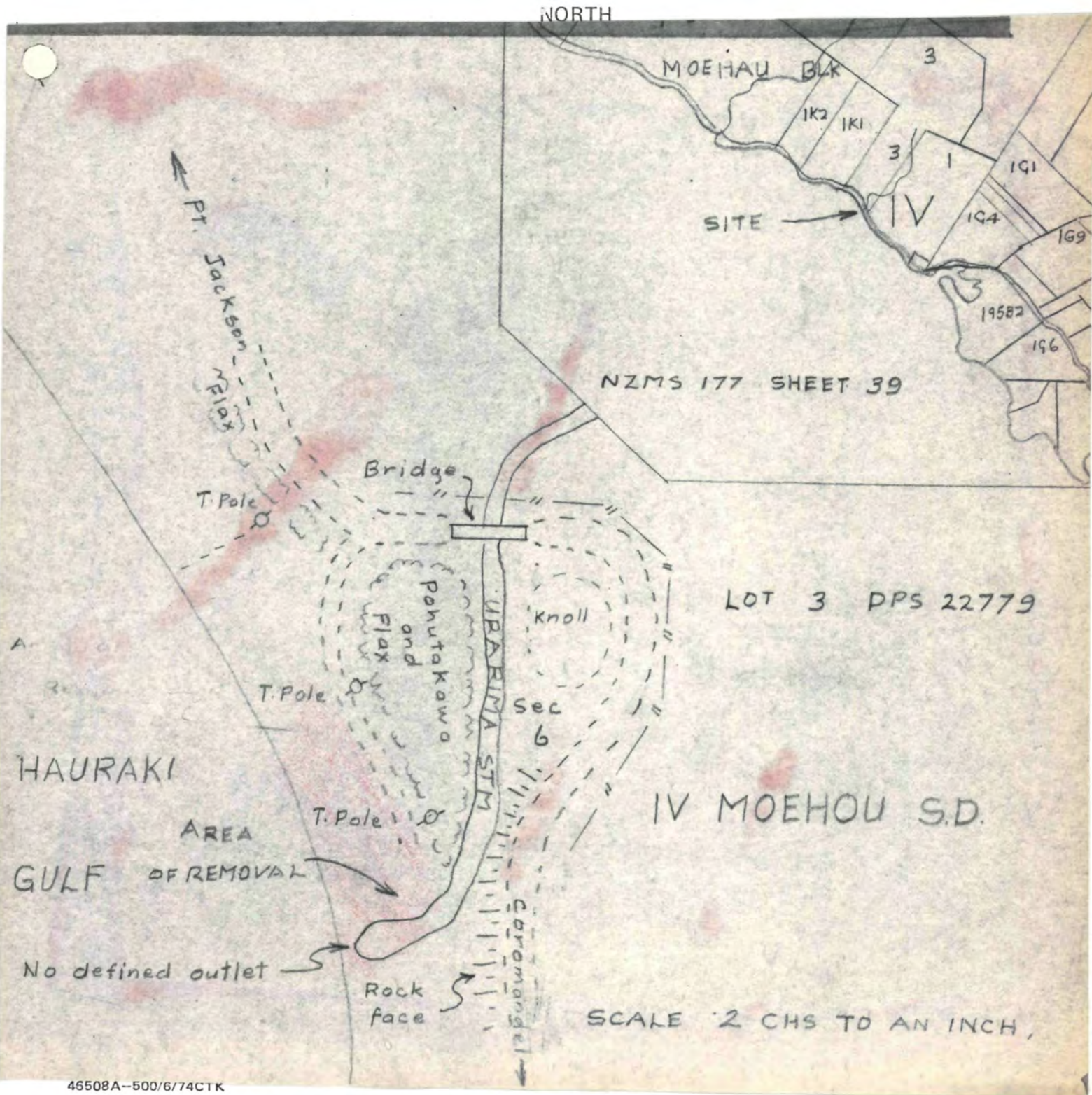

ENVIRONMENTAL ASSESSMENT

1. Describe the topography of the area from which material is to be extracted, and adjoining beach, e.g. cliffs, dunes. Mouth of stream with rocky cliffs north and shingle beach south ..
2. Describe length and depth of the foreshore concerned, or adjoining. As Above
3. Describe specification of material required. Shingle
4. Describe availability of this material at location applied for. Continuous supply from shingle carrying stream and tidal action.
5. Report nearest alternative source. Melsopps
6. Report use of the material and demand for it. Road maintenance as required
7. Report minimum quantity required. 1000m³
8. Give details of present land use behind the beach, e.g. farming (type), residential, recreational, industrial. Nearest residential areas. Public motor camp with dry stock farming behind.
9. Describe vegetative cover behind the beach, e.g. grass, lupins, scrub. Grass
10. Report probable effect on physical environment. Nil
11. Would the operation affect a scenic area. No
12. Would the operation affect the ecology, fish, shell-fish or bird life. No
13. Comment on any recreational activity on the beach or adjacent area which might be affected, e.g. boating, fishing, picnicing. All recreational activities are carried out in the area, none of which would be affected
14. Would the operation involve the construction of buildings, stock piles or deep holes. No
15. Method of extraction. Front end loader.
16. Alternative methods of extraction available. Nil
17. Report survey description of adjoining land and registered owner. See enclosed sketch plan.

19. Will the operation affect any historical or archeological sites. Check with New Zealand Historic Places Trust, Local Museum and New Zealand Archeological Association. NO
20. Are the operations likely to be of substantial public interest. Has there been any previous public concern about this type of operation in the region. Have any complaints been received in the last two years. NO
21. Will the operation create pollution, siltation or erosion. NO



MINISTRY of TRANSPORT

MARINE DIVISION

PRIVATE BAG
AUCKLAND
TELEPHONE: 34100-73-400

CUSTOM HOUSE
QUAY STREET
AUCKLAND

54/14/ 1

27/1 1978

James C. C. C.

Lyons St

Thames

Dear Sir

SAND AND SHINGLE LICENCES : PERIOD 1.1 TO 31.12. : AREA PAPA AKOHA

Receipt of your application is acknowledged. Reports are being obtained from our technical advisers and you will be informed of a decision in due course.

Yours faithfully

M. Greig
D. Greig
for Regional Secretary for Transport

Inspector of Mines and Quarries
P.O. Box 1701 34
AUCKLAND HUNTLY

... Copy for your information and action. Please find enclosed an application from the above to extract sand/shingle. Would you please comment to this office at an early date regarding any infringement the application may have on any mineral warrant or mining right in the area.

M. Greig
D. Greig
for Regional Secretary for Transport

Encl.

The District Commissioner of Works
Ministry of Works and Development

Private Bag
Hamilton

... Copy for your information and Action. Would you please make a report in terms of the Harbours Act 1950 to this office on the enclosed application to remove sand/shingle with due regard to any erosion which could be caused by the extraction of material.

M. Greig
D. Greig
for Regional Secretary for Transport

Encl.



APPLICATION FOR REMOVAL OF MATERIAL
SECTION 146A - HARBOURS ACT 1950

Three copies of this application, together with the maps and plans listed in section 12, are to be sent to the local Superintendent of Mercantile Marine. Addresses are listed overleaf.

Thames-Coromandel District Council

1. Applicant's name:
2. Address: Private Bag, THAMES.
3. Description of material to be removed: Shingle
4. Area material to be removed from: Adjacent to mouth of Papa Aroha stream, described as
S.O. 44779
5. Area described in Section 4 is: (tick in appropriate box)
 - (a) between mean high water and low water (ordinary spring tides)
 - (b) below low water ordinary spring tides (i.e. seabed)
6. Describe method of extraction and transportation: Front end loader and trucks
7. Purpose material required for: Road maintenance
8. Quantity sought this calendar year: 1000m³
9. Rate of removal (state whether per day, week or month); or for smaller quantities date(s) of removal:
Not to exceed 90m³ per month.
10. Quantity extracted under previous year's licence if the same area is sought: 1000m³
11. Will an application for removal of material from this area be made next calendar year?
 - Yes Estimated quantity to be removed Similar
 - No
12. The following are attached:
 - (a) Three copies of form MOT 5908 showing the area from which material is to be removed.
 - (b) Three copies of map NZMS 177 showing the locality.

Signature: For K.C. Fenton Chief Engineer
Thames-Coromandel District Council

Name of Company, etc., if applicable:

Date: ... 19 January 1978

ADDRESS OF LOCAL OFFICES OF SUPERINTENDENTS OF MERCANTILE MARINE
(An officer of Ministry of Transport or Customs Department)

The actual designation of each officer is shown with the address:

AUCKLAND	..	Regional Marine Officer, Ministry of Transport, Private Bag, Auckland.
BLUFF	..	District Administration Officer, Ministry of Transport, P.O. Box 18, Bluff.
CHATHAM ISLANDS	..	Superintendent of Mercantile Marine, Ministry of Transport, P.O. Box 72, Waitangi, Chatham Islands.
CHRISTCHURCH	..	Regional Marine Officer, Ministry of Transport, Private Bag, Christchurch.
DUNEDIN	..	District Officer, Ministry of Transport, Private Bag, Dunedin.
GISBORNE	..	Superintendent of Mercantile Marine, Customs Department, P.O. Box 17, Gisborne.
GREYMOUTH	..	Superintendent of Mercantile Marine, Customs Department, Box 40, Greymouth.
NAPIER	..	District Officer, Ministry of Transport, P.O. Box 4145, Marewa, Napier.
NELSON	..	District Administration Officer, Ministry of Transport, P.O. Box 192, Nelson.
NEW PLYMOUTH	..	District Officer, Ministry of Transport, P.O. Box 4041, New Plymouth East.
PICTON	..	Superintendent Mercantile Marine, Ministry of Transport, P.O. Box 59, Picton.
TAURANGA	..	Superintendent of Mercantile Marine, Customs Department, P.O. Box 317, Tauranga.
TIMARU	..	Superintendent of Mercantile Marine, Customs Department, P.O. Box 64, Timaru.
WANGANUI	..	Superintendent of Mercantile Marine, Customs Department, P.O. Box 130, Wanganui.
WELLINGTON	..	Regional Marine Officer, Ministry of Transport, P.O. Box 27-144, Wellington.
WHANGAREI	..	District Administration Officer, Ministry of Transport, P.O. Box 150, Whangarei.
WESTPORT	..	Secretary Manager, Ministry of Transport, P.O. Box 29, Westport.



PLAN OF AREA SOUGHT FOR REMOVAL OF MATERIAL

SECTION 146A - HARBOURS ACT 1950

Instructions:

- (i) Complete in triplicate and attach to each copy of the application form MOT 5907.
- (ii) Show on this plan area of removal.
- (iii) Landmarks, adjacent title boundaries and measurements (or scale) are required.
- (iv) Attach to this plan - again three copies required - copies or tracing of portion NZMS map series 177 - arrow the area. Show NZMS map NUMBER from which tracing made.

NORTH

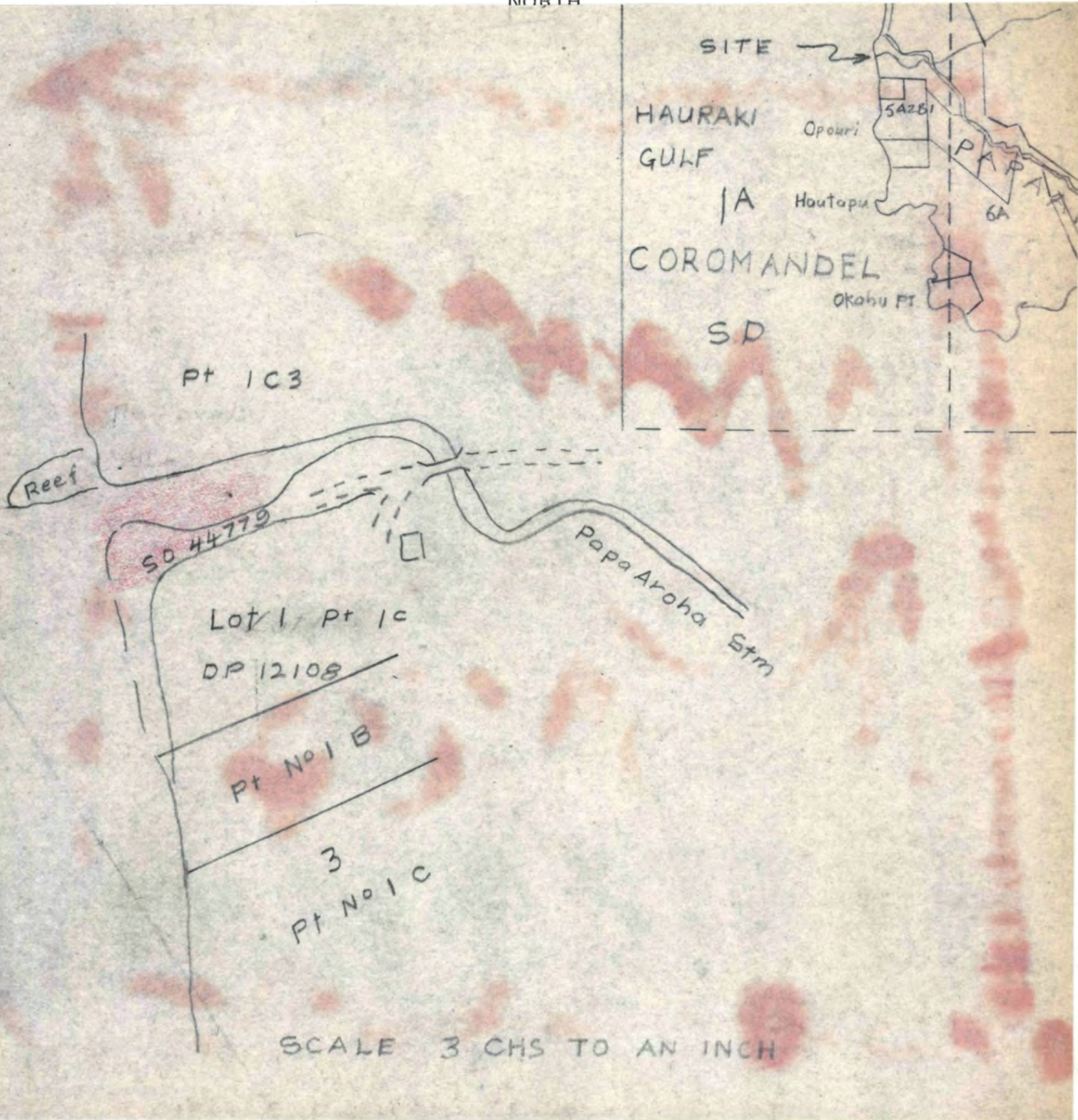

Enclosure No. 1

ENVIRONMENTAL ASSESSMENT

1. Describe the topography of the area from which material is to be extracted, and adjoining beach, e.g. cliffs, dunes. *Mouth of shingle bearing str. Shingle beach south side cliffs north side*
2. Describe length and depth of the foreshore concerned, or adjoining.
3. Describe specification of material required. *1" - 2" Shingle*
4. Describe availability of this material at location applied for. *Continuous deposit from stream and by tidal action*
5. Report nearest alternative source. *Unarima Str - Melleopp crossing*
6. Report use of the material and demand for it. *Roading purposes*
7. Report minimum quantity required. *1000 m³*
8. Give details of present land use behind the beach, e.g. farming (type), residential, recreational, industrial. Nearest residential areas. *Papa aroha motor camp.*
9. Describe vegetative cover behind the beach, e.g. grass, lupins, scrub. *grass.*
10. Report probable effect on physical environment. *Nil*
11. Would the operation affect a scenic area. *No*
12. Would the operation affect the ecology, fish, shell-fish or bird life. *No*
13. Comment on any recreational activity on the beach or adjacent area which might be affected, e.g. boating, fishing, picnicing. *& swimming but not affected*
14. Would the operation involve the construction of buildings, stock piles or deep holes. *No.*
15. Method of extraction. *Loader.*
16. Alternative methods of extraction available. *Nil.*
17. Report survey description of adjoining land and registered owner. *Lots 1 & 2 DP12108
Papa aroha 14.
Blk 1A Coromandel S.D.
Owners: Lenvick Invest. NZ Ltd.*

*Papa aroha 1D1A Pt 1C3 Blks.
Blk 1A Coromandel S.D.
Crown Land.*

19. Will the operation affect any historical or archeological sites. Check with New Zealand Historic Places Trust, Local Museum and New Zealand Archeological Association.
20. Are the operations likely to be of substantial public interest. Has there been any previous public concern about this type of operation in the region. Have any complaints been received in the last two years.
21. Will the operation create pollution, siltation or erosion.

Nil

No

No

MD:EX

54/4/7/6

Telephone:
73-400

Northern Regional Office,
Private Bag,
AUCKLAND 1.

3 December 1976

The General Manager,
Thames-Coromandel District Council,
Private Bag,
THAMES.

Dear Sir,

APPLICATION FOR REMOVAL OF MATERIAL

1977

... AS we require three copies of application forms for
each area of extraction, please complete the enclosed
eight copies MOT 5907 and 5908 and the Environmental
Assessment.

Yours faithfully,

(D.J. Greig)
for Regional Secretary
for Transport

54/14/7/6

Thames - Coromandel District Council

TELEPHONES: 9 & 405 THAMES

PLEASE ADDRESS ALL CORRESPONDENCE TO: THE GENERAL MANAGER,
PRIVATE BAG, THAMES, N.Z.



Coromandel Division,
P.O. Box 1,
COROMANDEL.

If calling, please ask for
Mr Bartlett.

Please quote reference.



Coromandel Division

1 August 1977.

Marine Division,
Ministry of Transport,
Northern Regional Office,
Private Bag,
AUCKLAND.

Dear Sir

Re: Application for Removal of Material.

Would you please forward to Coromandel office 16 copies of forms M.O.T 5907 and 5908.

Also a supply of forms M.O.T. 5903.

Yours faithfully,

J.D. Bartlett

J.D. Bartlett,
AREA ENGINEER (CORO)

Application forms sent 4/8/77 htd



Thames - Coromandel District Council

TELEPHONES: 9 & 405 THAMES

PLEASE ADDRESS ALL CORRESPONDENCE TO: THE GENERAL MANAGER,
PRIVATE BAG, THAMES, N.Z.



If calling, please ask for

Mr Edmonds

Please quote reference.

10.5.6

14 February 1977

Regional Secretary for Transport,
Marine Division,
Ministry of Transport,
Private Bag,
AUCKLAND.

Attention: Mr Davies

Dear Sir,

Application for Removal of Material 1977

Acknowledging your letter of 3.2.77 and answering that no further action has been taken in this direction to date. You will be notified as the need arises.

Yours faithfully,

K.C. Fenton,
CHIEF ENGINEER.

Per:

54/14/7/6

Private Bag
AUCKLAND

3 February 1977

The General Manager
Thames-Coromandel District Council
Private Bag
THAMES

Dear Sir,

Application for Removal of Material 1977

Further to our letter dated 3rd December 1976 no action can be taken for the removal of shingle until you return the Eight application forms MOT 5907, as these are required for our Technical Advisors.

Please give this matter your urgent attention.

Yours faithfully,



D. Greig
for Regional Secretary for Transport

Application Forms sent 6/10/76

Advised no returns submitted to date

MTS

MINUTE SHEET

Department: *W. H. Taylor*

Subject:

*Shingle removal licenses
1976.*File No. *54/14/7/6*Date: *22/12/75*

To—

*20 The County Engineer
Thames Coromandel District Council
P.O. Box 400.*

Thames.

Dear Sir,

*please find enclosed shingle removal
licenses for the extraction areas requested.
for the year commencing 1.1.76.*

*Your attention is drawn to the amount
allocated and you requested to ensure
that staff extracting material are aware
of the conditions which appear on the licenses*

Yours faithfully

D. Greig

F.R. FT

This form must be produced when demanded by an officer or representative of the Marine Department

Reference: 54/141 7/6

LICENCE TO TAKE MATERIAL

Pursuant to the Harbours Act 1950

N^o 2623

To The County Engineer

Address: Thames Command County Council
Box 400 - Thames

You are hereby authorised on payment of a licence fee of 10s. (\$1), and subject to the terms and conditions set out below, to take and remove 600 cubic yards per ANNUM of *stone, shingle, sand, boulders, silt, mud, from an area of the *foreshore below high-water mark, harbour, river bed, bed of the sea, described as Goat Bay

TERMS AND CONDITIONS

1. This licence shall expire on the 31st day of December 1975 unless sooner revoked in terms hereof.

2. The licensee shall pay to the Marine Department a royalty of all material taken and removed at the rate of N/A per cubic yard m³

*3. The licensee shall, on the first day of each month, produce for inspection to at his cargo book and official log book as required by section 177 of the Shipping and Seamen Act 1952, and shall thereupon pay all amounts (if any) due to date, or

4. The licensee shall, on the first day of each (month) (or of the quarters commencing in January, April, July, and October*), produce to at a record of all material removed each day during the preceding (month*) (or quarter*), or, if no material has been removed during that period, advise him in writing accordingly, and shall thereupon pay all amounts (if any) due to date.

5. The licensee shall not remove any material from any place which, although included in the area above described, is used in whole or in part as a public road or highway.

6. The licensee shall not assign or subcontract out the benefit of this licence.

7. This licence may be revoked upon one week's written notice to the licensee at the above address and without notice if:

- (a) The Department considers damage is being done or is likely to be done to adjacent land, or
- (b) If the licensee, his servants, or agents shall fail to observe any term or condition hereof without in any event prejudice to other rights of the Department including its right of recovery of payments due hereunder.

8. Further conditions: The Applicant must restore the Working Area after each extraction operation. All holes must be backfilled and the beach left in a safe, neat and tidy condition at all times. Extraction operations should be limited to the forward edge of materials at the approved site at any time.
DATED this 16 day of December 1975

Signature: M. Davies
Designation: Foreshore Assistant

*Delete as necessary.

This form must be produced when demanded by an officer or representative of the Marine Department

Reference: 54/14/7/6

LICENCE TO TAKE MATERIAL

Pursuant to the Harbours Act 1950

No 2622

To The County Engineer

Address: Thames Coromandel County Council
Box 400 - Thames

You are hereby authorised on payment of a licence fee of 10s. (\$1), and subject to the terms and conditions set out below, to take and remove 1500 cubic ^M yards per ANNUM of *stone, shingle, sand, boulders, silt, mud, from an area of the *foreshore below high-water mark, harbour, river bed, bed of the sea, described as Mellsapps

TERMS AND CONDITIONS

- 1. This licence shall expire on the 31st day of December 1975 unless sooner revoked in terms hereof.
- 2. The licensee shall pay to the Marine Department a royalty of all material taken and removed at the rate of N/C per cubic yard M.
- *3. The licensee shall, on the first day of each month, produce for inspection to _____ at _____ his cargo book and official log book as required by section 177 of the Shipping and Seamen Act 1952, and shall thereupon pay all amounts (if any) due to date, or
- *4. The licensee shall, on the first day of each (month*) (or of the quarters commencing in January, April, July, and October*), produce to _____ at _____ a record of all material removed each day during the preceding (month*) (or quarter*), or, if no material has been removed during that period, advise him in writing accordingly, and shall thereupon pay all amounts (if any) due to date.
- 5. The licensee shall not remove any material from any place which, although included in the area above described, is used in whole or in part as a public road or highway.
- 6. The licensee shall not assign or subcontract out the benefit of this licence.
- 7. This licence may be revoked upon one week's written notice to the licensee at the above address and without notice if:
 - (a) The Department considers damage is being done or is likely to be done to adjacent land, or
 - (b) If the licensee, his servants, or agents shall fail to observe any term or condition hereof
 without in any event prejudice to other rights of the Department including its right of recovery of payments due hereunder.

8. Further conditions: The extraction Area must be left in the level condition
All extraction holes being back filled and the Area left in a neat
& tidy condition

DATED this 16th day of December 1975

Signature: M. Davis

Designation: Foreshore Assistant

*Delete as necessary.

This form must be produced when demanded by an officer or representative of the Marine Department

Reference: 24/14/7/6

LICENCE TO TAKE MATERIAL

Pursuant to the Harbours Act 1950

No 2621

To The County Engineer

Address: Thames Coromandel County Council
Box 400 - Thames

You are hereby authorised on payment of a licence fee of 10s. (\$1), and subject to the terms and conditions set out below, to take and remove 200 cubic yards per annum of stone, shingle, sand, boulders, silt, mud, from an area of the foreshore below high-water mark, harbour, river bed, bed of the sea, described as Okahutahi Stream

TERMS AND CONDITIONS

- 1. This licence shall expire on the 31st day of December 1975 unless sooner revoked in terms hereof.
2. The licensee shall pay to the Marine Department a royalty of all material taken and removed at the rate of N/C per cubic yard.
3. The licensee shall, on the first day of each month, produce for inspection to his cargo book and official log book as required by section 177 of the Shipping and Seamen Act 1952, and shall thereupon pay all amounts (if any) due to date, or
4. The licensee shall, on the first day of each (month*) (or of the quarters commencing in January, April, July, and October*), produce to a record of all material removed each day during the preceding (month*) (or quarter*), or, if no material has been removed during that period, advise him in writing accordingly, and shall thereupon pay all amounts (if any) due to date.
5. The licensee shall not remove any material from any place which, although included in the area above described, is used in whole or in part as a public road or highway.
6. The licensee shall not assign or subcontract out the benefit of this licence.
7. This licence may be revoked upon one week's written notice to the licensee at the above address and without notice if:
(a) The Department considers damage is being done or is likely to be done to adjacent land, or
(b) If the licensee, his servants, or agents shall fail to observe any term or condition hereof without in any event prejudice to other rights of the Department including its right of recovery of payments due hereunder.

8. Further conditions: The licensee to restore working area by levelling off after each removal by back fillings. Removals to take place only at times when material available over extraction area and restricted to Area applied for.

DATED this 16th day of December 1975

Signature: M. Davies
Designation: Foreshore Assistant

*Delete as necessary.

This form must be produced when demanded by an officer or representative of the Marine Department

Reference: 54/14/7/6

LICENCE TO TAKE MATERIAL

Pursuant to the Harbours Act 1950

No 2620

To: The County Engineer
Address: Thames Board and District Council
Box 400 - Thames

You are hereby authorised on payment of a licence fee of 10s. (\$1), and subject to the terms and conditions set out below, to take and remove 1000 cubic yards per ANNUM of *stone, shingle, sand, boulders, silt, mud, Removals not to exceed the maximum of 140 per month. from an area of the *foreshore below high-water mark, harbour, river bed, bed of the sea, described as Papa Aroha

TERMS AND CONDITIONS

1. This licence shall expire on the 31st day of December 1976 unless sooner revoked in terms hereof.
2. The licensee shall pay to the Marine Department a royalty of all material taken and removed at the rate of N/A per cubic yard.
- *3. The licensee shall, on the first day of each month, produce for inspection to _____ at _____, his cargo book and official log book as required by section 177 of the Shipping and Seamen Act 1952, and shall thereupon pay all amounts (if any) due to date, or
- *4. The licensee shall, on the first day of each (month*) (or of the quarters commencing in January, April, July, and October*), produce to _____ at _____ a record of all material removed each day during the preceding (month*) (or quarter*), or, if no material has been removed during that period, advise him in writing accordingly, and shall thereupon pay all amounts (if any) due to date.
5. The licensee shall not remove any material from any place which, although included in the area above described, is used in whole or in part as a public road or highway.
6. The licensee shall not assign or subcontract out the benefit of this licence.
7. This licence may be revoked upon one week's written notice to the licensee at the above address and without notice if:
 - (a) The Department considers damage is being done or is likely to be done to adjacent land, or
 - (b) If the licensee, his servants, or agents shall fail to observe any term or condition hereof
 without in any event prejudice to other rights of the Department including its right of recovery of payments due hereunder.

8. Further conditions: The licensee to restore working area by levelling off after each removal by back filling. Removals to take place only at times when material available over retraction area and restricted to area applied for

DATED this 16th day of December 1975

Signature: M. Davies
Designation: Foreshore Assistant

*Delete as necessary.

Leonard County Council Conditions

- ① Lake Awoha - Removal only 1000 m³
per annum with maximum of 90m³ per month. ✓
- ② Licenses to restore working area by breeding
off after each removal by best filling ✓
- ③ Removal to take place only at times
when material available over extraction ✓
area x activities to area applied to

Okakuli Stream Removal of 200 m³
subject to conditions above 2 x 3

Melrope Alwechar 1500 m³ ✓

Great Bay 600 m³

Private Bag
HAMILTON

62899

47/16

26 November 1975

Mr A K Attwood

Regional Secretary
Marine Division
Ministry of Transport
Private Bag
AUCKLAND

ATTENTION Mr D Greig

SAND AND SHINGLE LICENCES

Goat Bay 54/14/7/16 of 20 October 1975

Urarima Stream (Hellsops) 54/14/7/6 of 20 October 1975

Papa - Aroha 54/14/7/6 of 20 October 1975

Okahutahi Stream (Sandy Bay) 54/14/7/6 of 20 October 1975

✓ Mercury Bay ReadyMix Ltd 54/14/7/44 of 24 October 1975

✓ A.A. Simpson Whitianga 54/14/7/4 of 22 October 1975

... Enclosed are reports submitted by the resident engineer Paeroa on all of the above applications. The recommendations made are endorsed by this office.

It is our intention to formulate proposals for a detailed study of the beaches and forjourns in the Coromandel Peninsula and Bay of Plenty Coastline. The need for such a study is being created by the erosion already occurring of various parts of the coast and also the significant amounts of sand being removed under licence from some beaches. It could be as well to inform operators of this proposed study the end result of which could well be the recommendation not to issue any further licences for sand and shingle extraction from beaches.

I am particularly concerned at the appearance of the Papa Aroha Beach and would particularly stress the recommended reduction in the quantity to be licenced. The resident engineer has reservations that the nominated rates of removal are being grossly exceeded and also wonders whether the annual quantity removed is being held within the licenced quantities. In the case of the concrete manufacturers possibly this figure can be approximately checked by examining the total quantity of concrete produced each year. Within the terms of the licence does any provision exist for checking on the operators returns of quantities.

R E Hermans
District Commissioner of Works

Per

A K Attwood

Encl (A K Attwood)



Our Ref: 7/2

Date: 11 November 1975

Inquiries to: P Hardy

Dist Commr of Works
M W D
HAMILTON

ATTENTION Mr A K Attwood

Your Ref: 47/16 of 20 October 1975

SAND AND SHINGLE LICENCE : PAPA-AROA

1 This area was inspected on Tuesday, 4 November 1975. At the time of inspection there were signs of fairly recent removal of sand/gravel beach materials from this site.

It was estimated that up to 300 m³ had been removed. No effort had been made to tidy the working area in anyway. A working face and hole excavation common to the use of front end loader type of extraction of beach materials was left at the site.

2 General

From inspection this site is situated immediately on the south bank at the mouth of a small tidal stream. (Haunonit?). Access to the site is directly off State Highway 25, via a small culverted crossing of the stream then along the south bank to the mouth. This access also serves as the main access to the Papa-Aroha Camping ground, a popular holiday camping area. The whole of the licence site is influenced by tidal action. The access to the beach gravel site also forms part of the available materials for removal. Shape of the site is roughly triangular, running for 100 metres from the culvert crossing of the stream to the beach with a beach frontage of approximately 50 metres.

The site is confined on the south by trees, grassed bank and other vegetation growth. The access road level is approximately .6 of a metre above normal high tide level.

It is possible that the sand gravel material available in the area could extend to a depth of 1½ metres below the access road level. If this is the case the area could yield approximately 3500 cubic metres. Not all of this material would be available if an access track and working area was to be maintained but up to 2000 cubic metres could be removed.

It was noted from the inspection that the mouth of the stream is bounded on the north east bank by a high 5 to 8 metre clay vertical cliff covered in vegetation. A reef extends into the sea from the foot of this cliff. The reef is exposed at low tide level.

The stream mouth is situated at the north eastern end of a shallow saucer shaped beach approximately 1 kilometre in length. Generally the beach, which is predominantly a gravel and sand mixture is backed by a well grassed frontage. At low tide approximately 10-15 metres of beach is exposed. There is a noticeable half to 1 metre step from the beach to the grassed frontage. Some change was noted at the south west end of the beach. There is a concreted boatramp 4 metres wide 100 metres south west of the mouth of the stream.

It is not known where the present source of beach materials comes from. Some alluvial gravels and sands will of course be discharged during periods of flooding from the stream proper but the beach could be supplied by tidal drift or from the local sea bed materials.

From the shape of the beach i.e. short, sharp strike off to low tide level and the development of a vertical face along the beach berm line, it is possible that in periods of low alluvial discharge from the stream or even lack of material from the sea bed locally that most of the sand/gravel restoration occurring at the mouth of this stream is by material migration locally along the beach itself caused by tidal and wave action.

It was noted that some build up of beach materials was occurring in the vicinity of the concreted boat-ramp. The combination of the reef on the mouth of the stream mouth plus the stream discharge to the sea would encourage the accumulation of materials on the immediate south bank of the stream mouth at the extraction site.

3

Recommendation

It is recommended that the licence approval be limited to a total extraction of 1000 m³ per annum. Rate of removal to be limited to 90 m³ per month or on availability of materials at any one time. The area of extraction should be limited to the site indicated on the plan i.e. immediately south of the mouth of the stream.

The licensee must restore the working area by levelling off the area and back-filling any excavation holes.

It is noted there are other sources of road metal material available within this area. There is a site 1.5 kilometres south towards Coromandel, a second site 2.5 kilometres north along SH 25 towards Colville and a third site 8 kilometres north towards Colville. Although different materials would result and the method of winning these materials may be more difficult, these materials could be used as an alternative to the site required by the applicant.

Photos of this site were taken for reference purposes - copies are enclosed.

A W Stewart
Resident Engineer

per

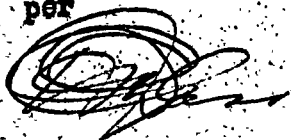

(H D Glass)

Encl



Our Ref: 7/2

Date: 11 November 1975

Inquiries to: P Hardy

Dist Commr of Works
M W D
HAMILTON

ATTENTION Mr A K Attwood

Your Ref: 47/16 of 20 October 1975

SAND AND SHINGLE LICENCES : OKAHUTAHU STREAM (SANDY BAY)

1 Site Inspection

This site was inspected on Tuesday, 4 November 1975. At the time of inspection there was a small stockpile of beach materials adjacent to the site (approximately 20 cubic metres). There was no evidence on the beach of recent extractions.

2 General

This beach is a popular area for holiday makers and has a substantial group of holiday homes adjacent to it. The beach has a pleasant, aesthetic appearance with a south facing aspect readily accessible by resident and itinerant visitors.

2 (E)
The extraction site is immediately adjacent to the mouth of the stream at the western end of the beach.

Due to the physical nature and shape of the beach and the confining western headland, the stream mouth is prone to periodic blocking by beach materials thrown up by abnormal tidal and wave action. This blocking of the stream mouth can cause flooding to the only access along the beach and it is possible that excessive flooding could cause the stream to force a new outlet further east along the beach thus endangering holiday houses constructed there.

The occasional removal of beach materials from this mouth at the site indicated, when conditions and material quantities permit would be beneficial to the beach generally.

3 Recommendation

As there was approximately 350 cubic metres of material available during the site inspection which occurred during a period of low tidal and wave action activity, I would recommend that the removal of 200 cubic metres of material be approved. However as the beach and working site is readily accessible by members of the public, care must be taken to ensure that the working site is restored to a safe, neat and tidy condition at all times. All holes must be backfilled and all heaps levelled off until normal beach shape is attained. Removal operations must be confined to periods when sufficient beach materials are available on the site indicated on the plan. Removal of beach materials other than at this site should be strictly prohibited.

I am extremely sceptical that the applicant proposes to remove only 15 cubic metres of material per month. Due to the site's location from centres of roading operations it would be a most uneconomical operation to transport plant to this site for this quantity of material i.e. 15 cubic metres per month.

••• Reference photos were taken of the site. Copies are enclosed.

A W Stewart
Resident Engineer

per



(H D Glass)

Encl



Our Ref: 7/2

Date: 11 November 1975

Inquiries to: P Hardy

Dist Commr of Works
H W D
HAMILTON

ATTENTION Mr A K Attwood

Your Ref: 47/16 of 20 October 1975

SAND AND SHINGLE LICENCES : URARIMA STREAM (MILLSOPS) C C C

1 Site Inspection

This site was inspected on Tuesday, 4 November 1975. At the time of inspection there was a stockpile of crushed materials of approximately 1100 m³.

A deep hole approximately 60 metres in length and 1.5 metres in depth had been left at the working site between the stockpile and the beach face.

2 General

From the inspection it was noted that this beach has quite an extensive supply of beach materials available. The beach is approximately 1.5 kilometres in length and the extraction site is about the centre of the beach.

The site is readily accessible being immediately adjacent to the road. The site is situated about 1.5 metres above normal high tide level, but is well within abnormal tidal range.

3 Recommendation

Due to the quantities of materials available on this beach I would recommend that the application for removal of 1500 m³ be approved.

However, due to the location of the site immediately adjacent to the road, and the fact that the access to the site also serves as access to the beach, the applicant must restore the working area after each extraction operation. All holes must be backfilled and the beach left in a safe, neat and tidy condition at all times.

... Reference photos were taken of this site. Copies are enclosed.

A W Stewart
Resident Engineer

per 

(H D Glass)

Encl



Our Ref: 7/2

Date: 11 November 1975

Inquiries to: P Hardy

Dist Commr of Works
H W D
HAMILTON

ATTENTION Mr A K Attwood

Your Ref: 47/16 of 20 October 1975

SAND AND SHINGLE LICENCES : GOAT BAY

1 Site Inspection

This site was inspected on Tuesday, 4 November 1975. At the time of inspection there was a small stockpile of beach gravel materials (approximately 30 m³) on the site. There was also evidence of extraction operations by front-end loader method i.e. excavation holes and small heaps of beach material.

2 General

This beach is the only beach accessible to the travelling public between Hallsops (Urarima Bay) and Port Jackson. The beach is not large, only 4-500 metres in length and is attractive aesthetically. Access to the beach also serves as access to the extraction site.

Due to the location of the mouth of the stream on this beach, available beach materials are limited and should be confined to the area shown on the plan, the site area not to exceed 50 metres x 20 metres at any time.

3 Recommendation

It is recommended that only 600 m³ of material be removed from this beach, depth of extraction not to exceed $\frac{2}{3}$ of 1 metre.

The applicant must restore the working area after each extraction operation. All holes must be backfilled and the beach left in a safe, neat and tidy condition at all times.

Extraction operations should be limited to the availability of materials at the approved site at any time.

Reference Photos were taken of the site. Copies are enclosed.

A W Stewart
Resident Engineer

per

(H D Glass)
Encl



MINES DEPARTMENT

Telephone 300 & 539

HUNTLY



Our Ref: 12/8
Your Ref: 54/14/7/6.

TELEGRAMS: MINES

Mines Dept,
P.O. Box 34,
HUNTLY

22 October, 1975

The Regional Secretary,
Ministry of Transport,
Marine Division,
Private Bag,
AUCKLAND.

SAND LICENCE APPLICATION

PAPA AROHA

Your memorandum of 20.10.75 refers.

There are no mining privileges in the area which would be affected by the grant of this application.

(A.G. Palmer)

Inspector of Mines & Quarries



MINES DEPARTMENT

Telephone 300 & 539

HUNTLY

Our Ref: 12/8
Your Ref: 54/14/7/6

TELEGRAMS: MINES

Mines Dept,
P.O. Box 34,
HUNTLY

22 October, 1975

The Regional Secretary,
Ministry of Transport,
Marine Division,
Private Bag,
AUCKLAND.

SAND LICENCE APPLICATION

URARIMA STREAM

Your memorandum of 20.10.75 refers.

There are no mining privileges in the area which would be affected by the grant of this application.

(A.G. Palmer)

Inspector of Mines & Quarries



MINES DEPARTMENT

Telephone 300 & 539

HUNTLY

Our Ref: 12/8
Your Ref: 54/14/7/6.

TELEGRAMS: MINES

Mines Dept,
P.O. Box 34,
HUNTLY

22 October, 1975

The Regional Secretary,
Ministry of Transport,
Marine Division,
Private Bag,
AUCKLAND.

SAND LICENCE APPLICATION

OKAHUTAKI STREAM - SANDY BAY

Your memorandum of 20.10.75 refers.

There are no mining privileges in the area which would be affected by the grant of this application.



.....
(A.G. Palmer)

Inspector of Mines & Quarries



MINES DEPARTMENT

Telephone 300 & 539

HUNTLY

Our Ref: 12/8
Your Ref: 54/14/7/16

TELEGRAMS: MINES

Mines Dept,
P.O. Box 34,
HUNTLY

22 October, 1975

The Regional Secretary,
Ministry of Transport,
Marine Division,
Private Bag,
AUCKLAND.

SAND LICENCE APPLICATION

THAMES-COROMANDEL DISTRICT COUNCIL

GOAT BAY

Your memorandum of 20.10.75 refers.

There are no mining privileges in the area which would be affected by the grant of this application.

(A.G. Palmer)

Inspector of Mines & Quarries



MARINE DIVISION - MINISTRY OF TRANSPORT

APPLICATION : REMOVAL OF MATERIAL
SECTION 146A - HARBOURS ACT 1950



- (1) COMPLETE IN TRIPLICATE
- (2) RETURN TO LOCAL OFFICE - ADDRESS ON REVERSE

1. Name of applicant: ~~So~~ *Thames Coromandel District Council*
2. Address: *Box 400 Thames*
3. Description of Material required: *Shingle*
4. Area from which sought: *Papa Uroha*
5. (a) Show area on sketch plan attached (Form MOT 5908) which should be completed in accordance with instructions thereon.
- (b) Show locality on tracing of NZMS 177 plan (Scale 1 inch to the mile)
- (c) Both plans to be in triplicate.
6. Purpose for which material required: *Roading*
7. Quantity sought to the end of the calendar year. *1200 m³*
8. Rate of removal (per day, week or month):
or for smaller quantities approximately date/s of removal:
Approx 100 m³ per month.
9. Indicate if a further application may be made for removal of material for the same area for a further quantity in the following calendar year:

Answer ~~(a) YES~~ - If so state estimated quantity

(b) NO

(Cross out which ever is not applicable)

Signature: *J.D. Bartlett*

Name of Company, etc. if applicable: *for T.C.D.C.*

Date: *14/10/75*

NOTE: THE APPLICATION AND PLANS ARE REQUIRED IN TRIPLICATE FOR REFERRING TO OTHER DEPARTMENTS FOR REPORTS.

ADDRESS OF LOCAL OFFICES OF
SUPERINTENDENTS OF MERCANTILE MARINE
(an officer of Ministry of Transport
or Customs Department)

The actual designation of each officer is
shown with the address:

AUCKLAND	Regional Marine Officer, Ministry of Transport, P.O. Box 4254, Auckland. /
BLUFF	Administration Officer, Ministry of Transport, P.O. Box 18, Bluff.
CHATHAM ISLANDS	Superintendent of Mercantile Marine, Ministry of Transport, P.O. Box 72, Waitangi, Chatham Islands
DUNEDIN	Administration Officer, Ministry of Transport, P.O. Box 1244, Dunedin
GISBORNE	Superintendent of Mercantile Marine, Customs Department, P.O. Box 17, Gisborne.
GREYMOUTH	Superintendent of Mercantile Marine, Customs Department, Box 40, Greymouth
NAPIER	District Officer, Ministry of Transport, P.O. Box 4145, Marewa, Napier
(PORT) NELSON	Administration Officer, Ministry of Transport, P.O. Box 1027, Port Nelson.
NEW PLYMOUTH	District Officer, Ministry of Transport, P.O. Box 4041, New Plymouth East.
PICTON	Administration Officer, Ministry of Transport, P.O. Box 59, Picton
TAURANGA	Superintendent of Mercantile Marine, Customs Department, P.O. Box 6, Tauranga
TIMARU	Superintendent of Mercantile Marine, Customs Department, P.O. Box 64, Timaru
WANGANUI	Superintendent of Mercantile Marine, Customs Department, P.O. Box 130, Wanganui
WELLINGTON	Regional Marine Officer, Ministry of Transport, P.O. Box 5066, Wellington.
WHANGAREI	Administration Officer, Ministry of Transport, P.O. Box 150, Whangarei
WESTPORT	Secretary Manager, Ministry of Transport, P.O. Box 29, Westport.



PLAN OF AREA SOUGHT FOR REMOVAL OF MATERIAL

SECTION 146A - HARBOURS ACT 1950

Instructions:

- (i) Complete in triplicate and attach to each copy of the application form MOT 5907.
- (ii) Show on this plan area of removal.
- (iii) Landmarks, adjacent title boundaries and measurements (or scale) are required.
- (iv) Attach to this plan - again three copies required - copies or tracing of portion NZMS map series 177 - arrow the area. Show NZMS map NUMBER from which tracing made.

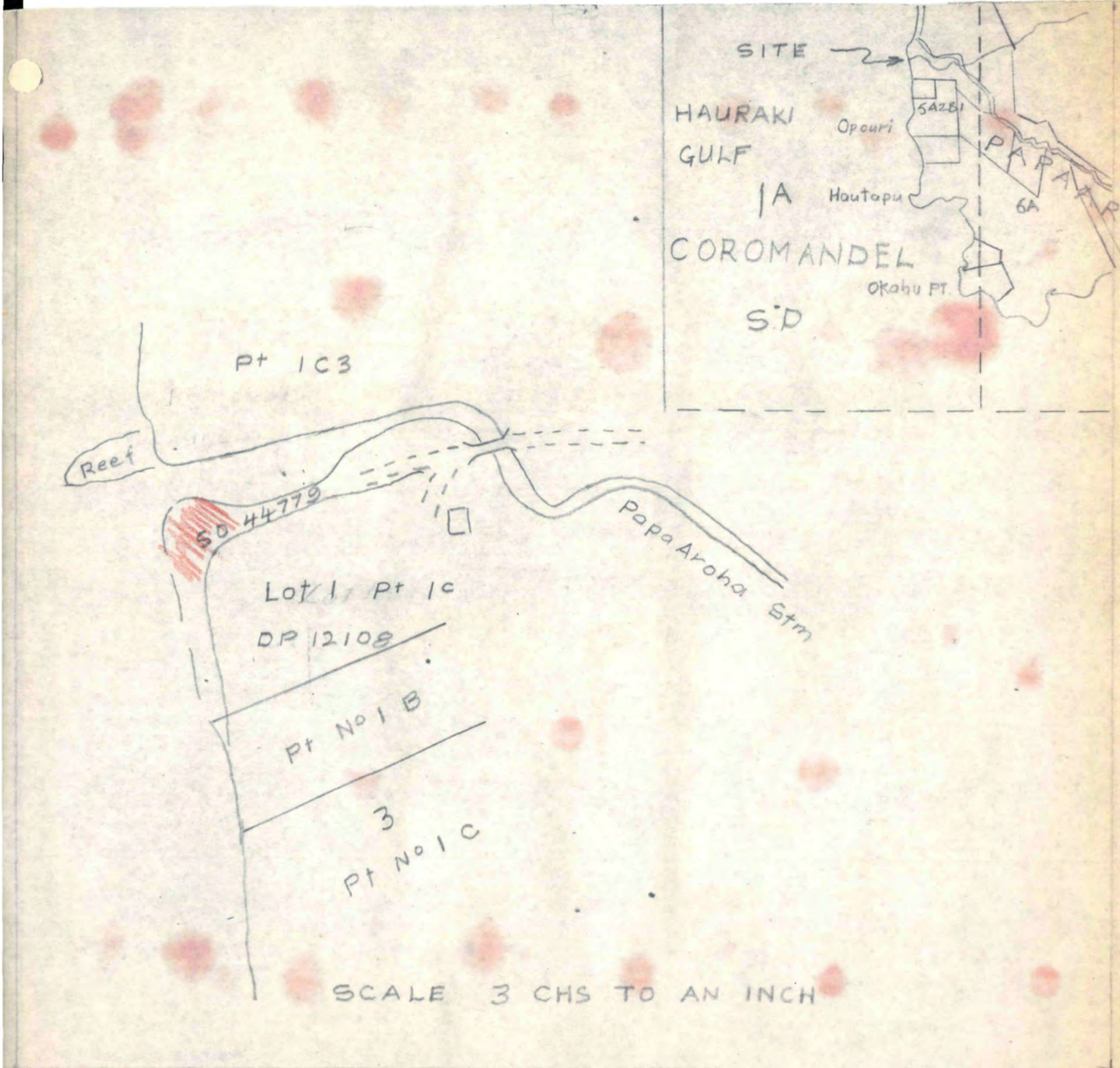

ENVIRONMENTAL ASSESSMENT

1. Describe the topography of the area from which material is to be extracted, and adjoining beach, e.g. cliffs, dunes. *Shingle bank at mouth of stream*
2. Describe length and depth of the foreshore concerned, or adjoining. *40 m x 20 m*
3. Describe specification of material required. *Shingle*
4. Describe availability of this material at location applied for. *Availability depends on tidal and weather conditions*
5. Report nearest alternative source. *Urasima Strm*
6. Report use of the material and demand for it. *Roading*
7. Report minimum quantity required. *1200 m³*
8. Give details of present land use behind the beach, e.g. farming (type), residential, recreational, industrial. Nearest residential areas. *Farm land and camping ground*
9. Describe vegetative cover behind the beach, e.g. grass, lupins, scrub. *Cyress*
10. Report probable effect on physical environment. *Nil*
11. Would the operation affect a scenic area. *No*
12. Would the operation affect the ecology, fish, shellfish or bird life. *No*
13. Comment on any recreational activity on the beach or adjacent area which might be affected, e.g. boating, fishing, picnicing. *All above activities are popular but would not be affected.*
14. Would the operation involve the construction of buildings, stock piles or deep holes. *No*
15. Method of extraction. *Loader*
16. Alternative methods of extraction available. *Nil*
17. Report mode of transport, e.g. barge, truck, rail and depot from which material is to be sold or distributed. *Trucked directly onto road.*
18. Report survey description of adjoining land and registered owner. *Lot 1 Pt 1C Blk 1A
Coromandel S.D.
Owner J. A. Ross.*

19. Will the operation affect any historical or archeological sites. Check with New Zealand Historic Places Trust, Local Museum and New Zealand Archeological Association. *No*
20. Are the operations likely to be of substantial public interest. Has there been any previous public concern about this type of operation in the region. Have any complaints been received in the last two years. *No*
21. Will the operation create pollution, siltation or erosion. *No.*

54/14/716

The Ministry of Transport,
Marine Division,
Private Bag,
AUCKLAND 1

20/10/71

Mr. County Engineer
Thames Coromandel District Council
Box 400 - Thames

Dear Sir,

SAND AND SHINGLE LICENCES
PERIOD 1.1.76 TO 31.12.76
AREA UKARIMA STM (MELLSOPPS)

Receipt of your application is acknowledged. Reports are being obtained from our technical advisers and you will be informed of a decision in due course.

Yours faithfully,

(D. Greig)
for Regional Secretary

The Inspector of Mines and Quarries,
P.O. Box 1701,
AUCKLAND

Copy for your information and action. Please find enclosed an application from the above to extract sand/shingle. Would you please comment to this office at an early date regarding any infringement the application may have on any mineral warrant or mining right in the area.

(D. Greig)
for Regional Secretary

Encl.

The District Commissioner of Works,
Ministry of Works,

Private Bag
HAMILTON

Copy for your information and action. Would you please make a report in terms of the Harbours Act 1950 to this office on the enclosed application to remove sand/shingle, with due regard to any erosion which could be caused by the extraction of material.

(D. Greig)
for Regional Secretary

Encl.



MARINE DIVISION - MINISTRY OF TRANSPORT

APPLICATION : REMOVAL OF MATERIAL
SECTION 146A - HARBOURS ACT 1950



- (1) COMPLETE IN TRIPLICATE
- (2) RETURN TO LOCAL OFFICE - ADDRESS ON REVERSE

1. Name of applicant: *Thames Coromandel District Council*
2. Address: *Box 400 Thames.*
3. Description of Material required: *Shingle*
4. Area from which sought: *Utarama Stm (Mellsopps)*
5. (a) Show area on sketch plan attached (Form MOT 5908) which should be completed in accordance with instructions thereon.
- (b) Show locality on tracing of NZMS 177 plan (Scale 1 inch to the mile)
- (c) Both plans to be in triplicate.
6. Purpose for which material required: *Roading*
7. Quantity sought to the end of the calendar year. *1500 m³*
8. Rate of removal (per day, week or month):
or for smaller quantities approximately date/s of removal:
Approx 125 m³ per month.
9. Indicate if a further application may be made for removal of material for the same area for a further quantity in the following calendar year:

Answer ~~(a) YES~~ If so state estimated quantity

(b) NO

(Cross out which ever is not applicable)

Signature: *J.D. Bartlett*

Name of Company, etc. if applicable: *for T.C.D.C.*

Date: *14/10/75.*

NOTE: THE APPLICATION AND PLANS ARE REQUIRED IN TRIPLICATE FOR REFERRING TO OTHER DEPARTMENTS FOR REPORTS.

ADDRESS OF LOCAL OFFICES OF
SUPERINTENDENTS OF MERCANTILE MARINE
(an officer of Ministry of Transport
or Customs Department)

The actual designation of each officer is
shown with the address:

AUCKLAND	<i>P.B</i> Regional Marine Officer, Ministry of Transport, P.O. Box 4254 , Auckland. /
BLUFF	Administration Officer, Ministry of Transport, P.O. Box 18, Bluff.
CHATHAM ISLANDS	Superintendent of Mercantile Marine, Ministry of Transport, P.O. Box 72, Waitangi, Chatham Islands
DUNEDIN	Administration Officer, Ministry of Transport, P.O. Box 1244, Dunedin
GISBORNE	Superintendent of Mercantile Marine, Customs Department, P.O. Box 17, Gisborne.
GREYMOUTH	Superintendent of Mercantile Marine, Customs Department, Box 40, Greymouth
NAPIER	District Officer, Ministry of Transport, P.O. Box 4145, Marewa, Napier
(PORT) NELSON	Administration Officer, Ministry of Transport, P.O. Box 1027, Port Nelson.
NEW PLYMOUTH	District Officer, Ministry of Transport, P.O. Box 4041, New Plymouth East.
PICTON	Administration Officer, Ministry of Transport, P.O. Box 59, Picton
TAURANGA	Superintendent of Mercantile Marine, Customs Department, P.O. Box 6, Tauranga
TIMARU	Superintendent of Mercantile Marine, Customs Department, P.O. Box 64, Timaru
WANGANUI	Superintendent of Mercantile Marine, Customs Department, P.O. Box 130, Wanganui
WELLINGTON	Regional Marine Officer, Ministry of Transport, P.O. Box 5066, Wellington.
WHANGAREI	Administration Officer, Ministry of Transport, P.O. Box 150, Whangarei
WESTPORT	Secretary Manager, Ministry of Transport, P.O. Box 29, Westport.



PLAN OF AREA SOUGHT FOR REMOVAL OF MATERIAL

SECTION 146A - HARBOURS ACT 1950

Instructions:

- (i) Complete in triplicate and attach to each copy of the application form MOT 5907.
- (ii) Show on this plan area of removal.
- (iii) Landmarks, adjacent title boundaries and measurements (or scale) are required.
- (iv) Attach to this plan - again three copies required - copies or tracing of portion NZMS map series 177 - arrow the area. Show NZMS map NUMBER from which tracing made.

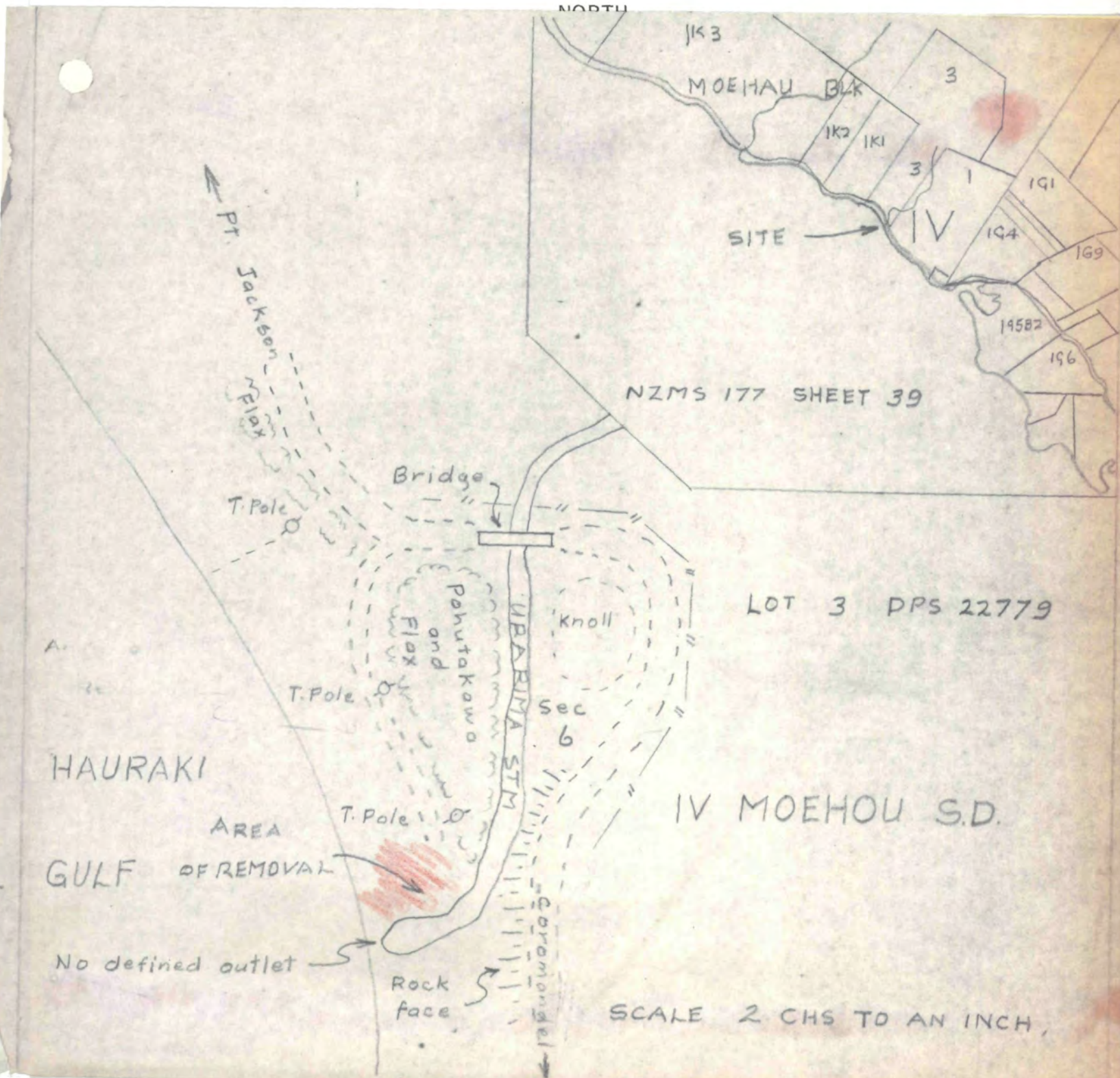

ENVIRONMENTAL ASSESSMENT

1. Describe the topography of the area from which material is to be extracted, and adjoining beach, e.g. cliffs, dunes. *Shingle beach backed by steep farm land*
2. Describe length and depth of the foreshore concerned, or adjoining. *Approx 40m x 40m*
3. Describe specification of material required. *Shingle*
4. Describe availability of this material at location applied for. *Generally available at all times.*
5. Report nearest alternative source. *Tidal conditions permitting Goat Bay.*
6. Report use of the material and demand for it. *Roading*
7. Report minimum quantity required. *1500 m³*
8. Give details of present land use behind the beach, e.g. farming (type), residential, recreational, industrial. Nearest residential areas. *Dry stock farming - Colville*
9. Describe vegetative cover behind the beach, e.g. grass, lupins, scrub. *Mainly flax & Pohutukawa.*
10. Report probable effect on physical environment. *Nil*
11. Would the operation affect a scenic area. *No*
12. Would the operation affect the ecology, fish, shellfish or bird life. *No*
13. Comment on any recreational activity on the beach or adjacent area which might be affected, e.g. boating, fishing, picnicking. *Some camping but not affected by operations*
14. Would the operation involve the construction of buildings, stock piles or deep holes. *No*
15. Method of extraction. *Loader*
16. Alternative methods of extraction available. *Nil*
17. Report mode of transport, e.g. barge, truck, rail and depot from which material is to be sold or distributed. *Trucked directly onto road.*
18. Report survey description of adjoining land and registered owner. *Lot 3 D.P.S. 22779
Blk IV Moehau S.D.
Owner M.C. Ward.*

19. Will the operation affect any historical or archeological sites. Check with New Zealand Historic Places Trust, Local Museum and New Zealand Archeological Association. *No.*
20. Are the operations likely to be of substantial public interest. Has there been any previous public concern about this type of operation in the region. Have any complaints been received in the last two years. *No*
21. Will the operation create pollution, siltation or erosion. *No.*

54/14/ / /

The Ministry of Transport,
Marine Division,
Private Bag,
AUCKLAND 1

Dear Sir,

SAND AND SHINGLE LICENCES
PERIOD 1.1.74 TO 31.12.74
AREA

Receipt of your application is acknowledged. Reports are being obtained from our technical advisers and you will be informed of a decision in due course.

Yours faithfully,

(D. Greig)
for Regional Secretary

The Inspector of Mines and Quarries,
P.O. Box 1701, 34
AUCKLAND *Hunter*

... Copy for your information and action. Please find enclosed an application from the above to extract sand/shingle. Would you please comment to this office at an early date regarding any infringement the application may have on any mineral warrant or mining right in the area.

Encl.

(D. Greig)
for Regional Secretary

The District Commissioner of Works,
Ministry of Works,

Private Bag
HAMILTON

... Copy for your information and action. Would you please make a report in terms of the Harbours Act 1950 to this office on the enclosed application to remove sand/shingle, with due regard to any erosion which could be caused by the extraction of material.

Encl.

(D. Greig)
for Regional Secretary



MARINE DIVISION - MINISTRY OF TRANSPORT

APPLICATION : REMOVAL OF MATERIAL
SECTION 146A - HARBOURS ACT 1950



- (1) COMPLETE IN TRIPLICATE
- (2) RETURN TO LOCAL OFFICE - ADDRESS ON REVERSE

1. Name of applicant: *Thames Coromandel District Council*
2. Address: *Box 400 Thames.*
3. Description of Material required: *Shingle.*
4. Area from which sought: *Mouth of Okahutahi Str. - Sandy Bay.*
5. (a) Show area on sketch plan attached (Form MOT 5908) which should be completed in accordance with instructions thereon.
- (b) Show locality on tracing of NZMS 177 plan (Scale 1 inch to the mile)
- (c) Both plans to be in triplicate.
6. Purpose for which material required: *Roading.*
7. Quantity sought to the end of the calendar year. *200 m³.*
8. Rate of removal (per day, week or month):
or for smaller quantities approximately date/s of removal:
Approx 15 m³ per month.
9. Indicate if a further application may be made for removal of material for the same area for a further quantity in the following calendar year:

Answer ~~(a) YES~~ - If so state estimated quantity

(b) NO

(Cross out which ever is not applicable)

Signature: *J.D. Bartlett*

Name of Company, etc. if applicable: *for T.C.D.C.*

Date: *14/10/75*

NOTE: THE APPLICATION AND PLANS ARE REQUIRED IN TRIPLICATE FOR REFERRING TO OTHER DEPARTMENTS FOR REPORTS.

ADDRESS OF LOCAL OFFICES OF
SUPERINTENDENTS OF MERCANTILE MARINE
(an officer of Ministry of Transport
or Customs Department)

The actual designation of each officer is
shown with the address:

AUCKLAND	<i>P.B.</i> Regional Marine Officer, Ministry of Transport, P.O. Box 1254, Auckland. /
BLUFF	Administration Officer, Ministry of Transport, P.O. Box 18, Bluff.
CHATHAM ISLANDS	Superintendent of Mercantile Marine, Ministry of Transport, P.O. Box 72, Waitangi, Chatham Islands
DUNEDIN	Administration Officer, Ministry of Transport, P.O. Box 1244, Dunedin
GISBORNE	Superintendent of Mercantile Marine, Customs Department, P.O. Box 17, Gisborne.
GREYMOUTH	Superintendent of Mercantile Marine, Customs Department, Box 40, Greymouth
NAPIER	District Officer, Ministry of Transport, P.O. Box 4145, Marewa, Napier
(PORT) NELSON	Administration Officer, Ministry of Transport, P.O. Box 1027, Port Nelson.
NEW PLYMOUTH	District Officer, Ministry of Transport, P.O. Box 4041, New Plymouth East.
PICTON	Administration Officer, Ministry of Transport, P.O. Box 59, Picton
TAURANGA	Superintendent of Mercantile Marine, Customs Department, P.O. Box 6, Tauranga
TIMARU	Superintendent of Mercantile Marine, Customs Department, P.O. Box 64, Timaru
WANGANUI	Superintendent of Mercantile Marine, Customs Department, P.O. Box 130, Wanganui
WELLINGTON	Regional Marine Officer, Ministry of Transport, P.O. Box 5066, Wellington.
WHANGAREI	Administration Officer, Ministry of Transport, P.O. Box 150, Whangarei
WESTPORT	Secretary Manager, Ministry of Transport, P.O. Box 29, Westport.



PLAN OF AREA SOUGHT FOR REMOVAL OF MATERIAL

SECTION 146A – HARBOURS ACT 1950

Instructions:

- (i) Complete in triplicate and attach to each copy of the application form MOT 5907.
- (ii) Show on this plan area of removal.
- (iii) Landmarks, adjacent title boundaries and measurements (or scale) are required.
- (iv) Attach to this plan – again three copies required – copies or tracing of portion NZMS map series 177 – arrow the area. Show NZMS map NUMBER from which tracing made.

NORTH

ENVIRONMENTAL ASSESSMENT

1. Describe the topography of the area from which material is to be extracted, and adjoining beach, e.g. cliffs, dunes. *Shingle stream. Sand beach to West High country to East.*
2. Describe length and depth of the foreshore concerned, or adjoining. *100m x 10m*
3. Describe specification of material required. *Shingle*
4. Describe availability of this material at location applied for. *Availability depends on tides and weather conditions.*
5. Report nearest alternative source. *Nil*
6. Report use of the material and demand for it. *Roading*
7. Report minimum quantity required. *200m³*
8. Give details of present land use behind the beach, e.g. farming (type), residential, recreational, industrial. Nearest residential areas. *Recreational and farming*
9. Describe vegetative cover behind the beach, e.g. grass, lupins, scrub. *grass*
10. Report probable effect on physical environment. *Nil*
11. Would the operation affect a scenic area. *No.*
12. Would the operation affect the ecology, fish, shellfish or bird life. *No.*
13. Comment on any recreational activity on the beach or adjacent area which might be affected, e.g. boating, fishing, picnicing. *All above recreational activities are popular but would not be affected.*
14. Would the operation involve the construction of buildings, stock piles or deep holes. *No.*
15. Method of extraction. *Loader.*
16. Alternative methods of extraction available. *Nil*
17. Report mode of transport, e.g. barge, truck, rail and depot from which material is to be sold or distributed. *Trucked directly onto road.*
18. Report survey description of adjoining land and registered owner. *Road Res.*

19. Will the operation affect any historical or archeological sites. Check with New Zealand Historic Places Trust, Local Museum and New Zealand Archeological Association. *No.*
20. Are the operations likely to be of substantial public interest. Has there been any previous public concern about this type of operation in the region. Have any complaints been received in the last two years. *No.*
21. Will the operation create pollution, siltation or erosion. *No. Removal of shingle at mouth of stream reduces flooding problems.*

54/14/ /

The Ministry of Transport,
Marine Division,
Private Bag,
AUCKLAND 1

The County Engineer
Thames Coromandel District Council

20/10

Dear Sir,

SAND AND SHINGLE LICENCES
PERIOD 1.1.76 TO 31.12.76
AREA

Receipt of your application is acknowledged. Reports are being obtained from our technical advisers and you will be informed of a decision in due course.

Yours faithfully,

(D. Greig)
for Regional Secretary

The Inspector of Mines and Quarries,
P.O. Box 1701, 34
AUCKLAND HUNTLEY.

... Copy for your information and action. Please find enclosed an application from the above to extract sand/shingle. Would you please comment to this office at an early date regarding any infringement the application may have on any mineral warrant or mining right in the area.

Encl.

(D. Greig)
for Regional Secretary

The District Commissioner of Works,
Ministry of Works,
Hamilton

... Copy for your information and action. Would you please make a report in terms of the Harbours Act 1950 to this office on the enclosed application to remove sand/shingle, with due regard to any erosion which could be caused by the extraction of material.

Encl.

(D. Greig)
for Regional Secretary



MARINE DIVISION - MINISTRY OF TRANSPORT

APPLICATION : REMOVAL OF MATERIAL
SECTION 146A - HARBOURS ACT 1950



- (1) COMPLETE IN TRIPLICATE
- (2) RETURN TO LOCAL OFFICE - ADDRESS ON REVERSE

1. Name of applicant: *Thames Coromandel District Council*
2. Address: *Box 400 Thames.*
3. Description of Material required: *Shingle.*
4. Area from which sought: *Goat Bay.*
5. (a) Show area on sketch plan attached (Form MOT 5908) which should be completed in accordance with instructions thereon.
- (b) Show locality on tracing of NZMS 177 plan (Scale 1 inch to the mile)
- (c) Both plans to be in triplicate.
6. Purpose for which material required: *Roading.*
7. Quantity sought to the end of the calendar year. *800^{m3}*
8. Rate of removal (per day, week or month):
or for smaller quantities approximately date/s of removal:
Approx 60^{m3} per month.
9. Indicate if a further application may be made for removal of material for the same area for a further quantity in the following calendar year:

Answer ~~(a) YES~~ - If so state estimated quantity

(b) NO

(Cross out which ever is not applicable)

Signature: *J.D. Bartlett*

Name of Company, etc. if applicable: *for T.C.D.C.*

Date: *14/10/75*

NOTE: THE APPLICATION AND PLANS ARE REQUIRED IN TRIPLICATE FOR REFERRING TO OTHER DEPARTMENTS FOR REPORTS.

ADDRESS OF LOCAL OFFICES OF
SUPERINTENDENTS OF MERCANTILE MARINE
(an officer of Ministry of Transport
or Customs Department)

The actual designation of each officer is
shown with the address:

AUCKLAND	<i>P.B</i> Regional Marine Officer, Ministry of Transport, P.O. Box 1254 , Auckland. /
BLUFF	Administration Officer, Ministry of Transport, P.O. Box 18, Bluff.
CHATHAM ISLANDS	Superintendent of Mercantile Marine, Ministry of Transport, P.O. Box 72, Waitangi, Chatham Islands
DUNEDIN	Administration Officer, Ministry of Transport, P.O. Box 1244, Dunedin
GISBORNE	Superintendent of Mercantile Marine, Customs Department, P.O. Box 17, Gisborne.
GREYMOUTH	Superintendent of Mercantile Marine, Customs Department, Box 40, Greymouth
NAPIER	District Officer, Ministry of Transport, P.O. Box 4145, Marewa, Napier
(PORT) NELSON	Administration Officer, Ministry of Transport, P.O. Box 1027, Port Nelson.
NEW PLYMOUTH	District Officer, Ministry of Transport, P.O. Box 4041, New Plymouth East.
PICTON	Administration Officer, Ministry of Transport, P.O. Box 59, Picton
TAURANGA	Superintendent of Mercantile Marine, Customs Department, P.O. Box 6, Tauranga
TIMARU	Superintendent of Mercantile Marine, Customs Department, P.O. Box 64, Timaru
WANGANUI	Superintendent of Mercantile Marine, Customs Department, P.O. Box 130, Wanganui
WELLINGTON	Regional Marine Officer, Ministry of Transport, P.O. Box 5066, Wellington.
WHANGAREI	Administration Officer, Ministry of Transport, P.O. Box 150, Whangarei
WESTPORT	Secretary Manager, Ministry of Transport, P.O. Box 29, Westport.



PLAN OF AREA SOUGHT FOR REMOVAL OF MATERIAL

SECTION 146A – HARBOURS ACT 1950

Instructions:

- (i) Complete in triplicate and attach to each copy of the application form MOT 5907.
- (ii) Show on this plan area of removal.
- (iii) Landmarks, adjacent title boundaries and measurements (or scale) are required.
- (iv) Attach to this plan – again three copies required – copies or tracing of portion NZMS map series 177 – arrow the area. Show NZMS map NUMBER from which tracing made.

NORTH

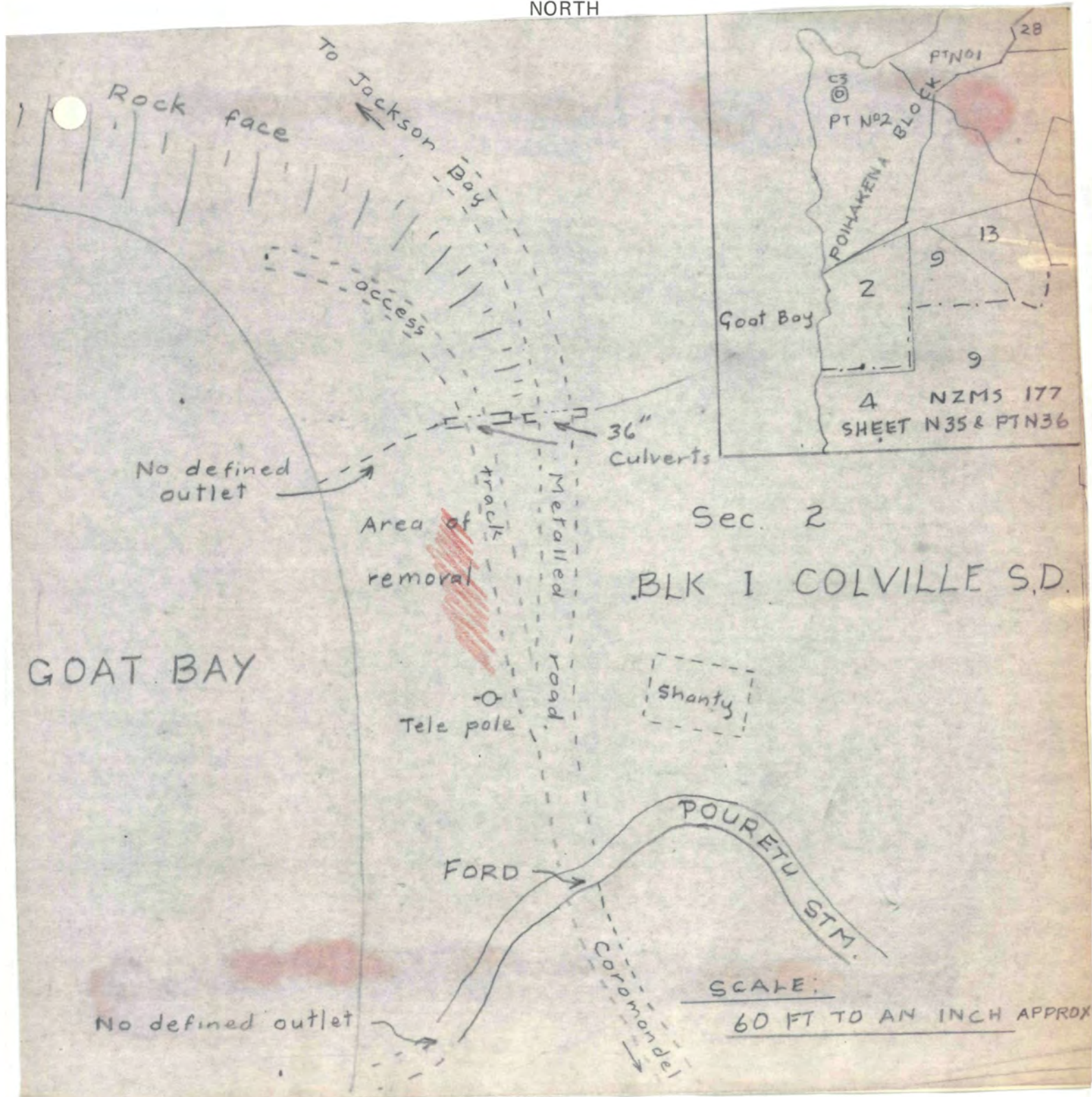

ENVIRONMENTAL ASSESSMENT

1. Describe the topography of the area from which material is to be extracted, and adjoining beach, e.g. cliffs, dunes. *Shingle beach backed by steep farm land.*
2. Describe length and depth of the foreshore concerned, or adjoining. *Approx 30m x 20m*
3. Describe specification of material required. *Shingle.*
4. Describe availability of this material at location applied for. *Availability depends on tidal action*
5. Report nearest alternative source. *Uranima Stm*
6. Report use of the material and demand for it. *Roading*
7. Report minimum quantity required. *800 m³*
8. Give details of present land use behind the beach, e.g. farming (type), residential, recreational, industrial. Nearest residential areas. *Dry stock farming - Colville.*
9. Describe vegetative cover behind the beach, e.g. grass, lupins, scrub. *Rough pasture & scrub.*
10. Report probable effect on physical environment. *Nil*
11. Would the operation affect a scenic area. *No.*
12. Would the operation affect the ecology, fish, shellfish or bird life. *No.*
13. Comment on any recreational activity on the beach or adjacent area which might be affected, e.g. boating, fishing, picnicing. *Very little recreational activity.*
14. Would the operation involve the construction of buildings, stock piles or deep holes. *No.*
15. Method of extraction. *Loader.*
16. Alternative methods of extraction available. *Nil*
17. Report mode of transport, e.g. barge, truck, rail and depot from which material is to be sold or distributed. *Trucked directly onto road.*
18. Report survey description of adjoining land and registered owner. *Road Res.*

19. Will the operation affect any historical or archeological sites. Check with New Zealand Historic Places Trust, Local Museum and New Zealand Archeological Association. *No.*
20. Are the operations likely to be of substantial public interest. Has there been any previous public concern about this type of operation in the region. Have any complaints been received in the last two years. *No.*
21. Will the operation create pollution, siltation or erosion. *No.*